

LinMot®

P01-37x240 (F)

Import Belgium & Luxembourg

Profilex s.a.

4A, Z.I. In den Allern Tel: 00352/99 89 06
L-9911 Troisvierges Fax: 00352/26 95 73 73

www.profilex-systems.com

profilex@pt.lu



The linear motor technology for industrial applications

Notes :

This image shows a blank sheet of white paper with horizontal ruling lines. The lines are evenly spaced and run across the width of the page. There are no margins, text, or other markings on the paper.

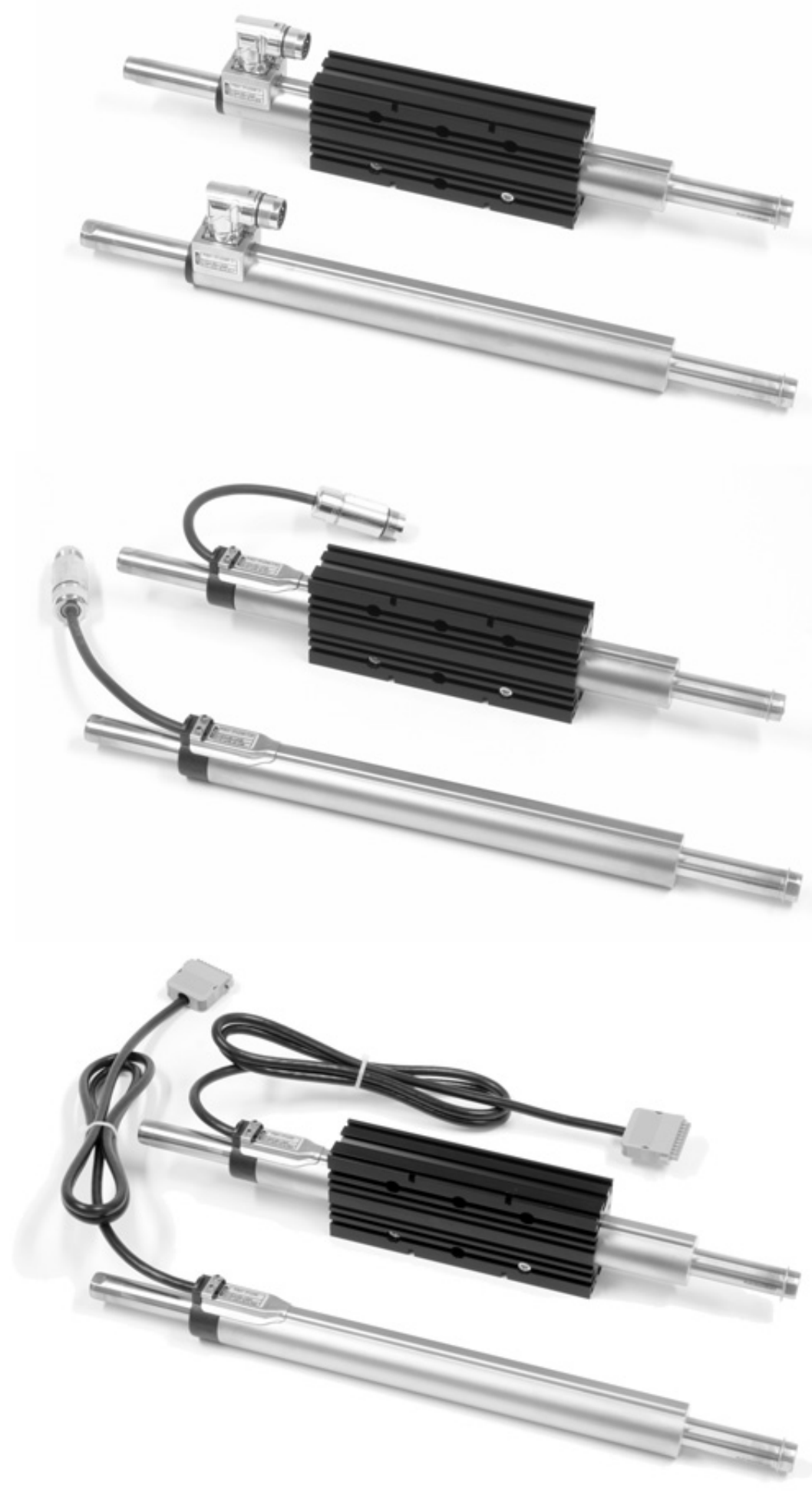

P01-37x240/100x100 132

P01-37x240/40x160 134

P01-37x240/60x260 136

P01-37x240/160x360 138

P01-37x240/260x460 140

P01-37x240/360x560 142

P01-37x240/460x660 144

P01-37x240/560x760 146

P01-37x240/660x860 148

P01-37x240/860x1060 150

P01-37x240/1060x1260 152

P01-37x240/1260x1460 154

Maximaler Hub: 100mm

Spitzenkraft: 180N

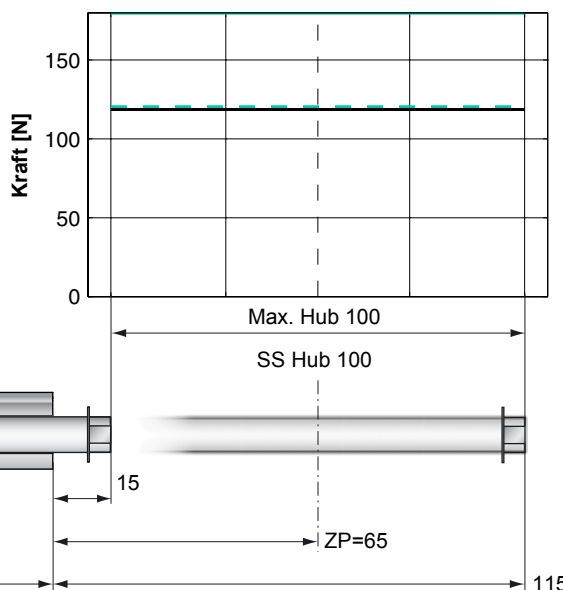

Standard Wicklung:

— E1100-HC, 72VDC
— E1100, 72VDC & E1001, 72VDC

F - Wicklung

— E1100-HC, 72VDC
- - E1100, 72VDC & E1001, 72VDC

Abmessungen mm
*Kabel Typ

Motor Spezifikation

| | | Stecker Typ | | Kabel Typ | |
|----------------------------|-------------|-------------------|-------------------|--------------------|---------------------|
| | | Standard Wicklung | F- Wicklung | Standard Wicklung | F- Wicklung |
| P01- | | 37x240/100x100-C | 37x240F/100x100-C | 37x240/100x100-C20 | 37x240F/100x100-C20 |
| Maximaler Hub | mm (in) | 100 (3.94) | 100 (3.94) | 100 (3.94) | 100 (3.94) |
| Kurzhubbereich SS | mm (in) | 100 (3.94) | 100 (3.94) | 100 (3.94) | 100 (3.94) |
| Spitzenkraft E1100-HC | N (lbf) | 119 (26.7) | 180 (40.4) | 119 (26.7) | 180 (40.4) |
| Spitzenkraft E1100 / E1001 | N (lbf) | 119 (26.7) | 120 (27.1) | 119 (26.7) | 120 (27.1) |
| Kont. Kraft | N (lbf) | 31 (7.0) | 31 (7.0) | 31 (7.0) | 31 (7.0) |
| Kont. Kraft mit Lüfter | N (lbf) | 58 (13.1) | 58 (13.1) | 58 (13.1) | 58 (13.1) |
| Randkraft | % | 100 | 100 | 100 | 100 |
| Kraftkonstante | N/A (lbf/A) | 23.8 (5.35) | 15.1 (3.38) | 23.8 (5.35) | 15.1 (3.38) |
| Max. Strom @ 72VDC | A | 5.0 | 11.9 | 5.0 | 11.9 |
| Max. Strom @ 48VDC | A | 3.3 | 8.0 | 3.3 | 8.0 |
| Max. Gesch. @ 72VDC | m/s (in/s) | 2.8 (110) | 4.4 (173) | 2.8 (110) | 4.4 (173) |
| Max. Gesch. @ 48VDC | m/s (in/s) | 1.9 (73) | 2.9 (116) | 1.9 (73) | 2.9 (116) |
| Phasenwider. 25/80 °C | Ohm | 11.7/14.2 | 4.9/5.9 | 11.7/14.2 | 4.9/5.9 |
| Phaseninduktivität | mH | 6.0 | 2.4 | 6.0 | 2.4 |
| Therm. Widerstand | °K/W | 2.3 | 2.2 | 2.3 | 2.2 |
| Therm. Zeitkonstante | sec | 3400 | 3200 | 3400 | 3200 |
| Statordurchmesser | mm (in) | 37 (1.46) | 37 (1.46) | 37 (1.46) | 37 (1.46) |
| Statorlänge | mm (in) | 336 (13.23) | 336 (13.23) | 347 (13.66) | 347 (13.66) |
| Statormasse | g (lb) | 1385 (3.05) | 1385 (3.05) | 1385 (3.05) | 1385 (3.05) |
| Läuferdurchmesser | mm (in) | 20 (0.79) | 20 (0.79) | 20 (0.79) | 20 (0.79) |
| Läuferlänge | mm (in) | 305 (12.01) | 305 (12.01) | 305 (12.01) | 305 (12.01) |
| Läufermasse | g (lb) | 496 (1.09) | 496 (1.09) | 496 (1.09) | 496 (1.09) |
| Wiederholgenauigkeit | mm (in) | ±0.05 (±0.0020) | ±0.05 (±0.0020) | ±0.05 (±0.0020) | ±0.05 (±0.0020) |
| Linearität | % | ±0.40 | ±0.40 | ±0.40 | ±0.40 |
| Wiederholgenauigk. ES | mm (in) | ±0.01 (±0.0004) | ±0.01 (±0.0004) | ±0.01 (±0.0004) | ±0.01 (±0.0004) |
| Linearität ES | mm (in) | ±0.01 (±0.0004) | ±0.01 (±0.0004) | ±0.01 (±0.0004) | ±0.01 (±0.0004) |

Hub-Zeit Diagramm

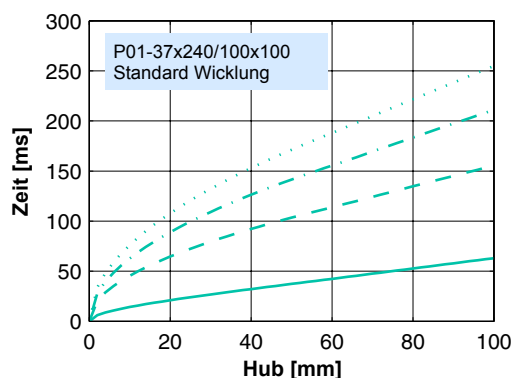

Bewegter Läufer

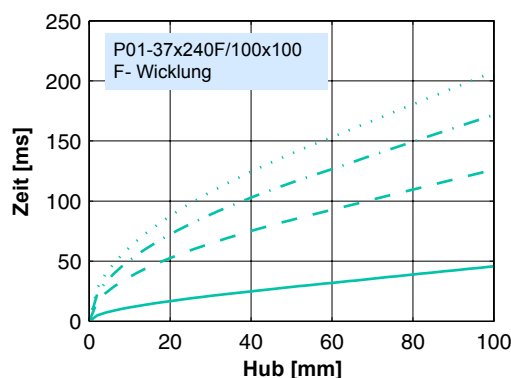

Bewegter Läufer

Stecker Typ

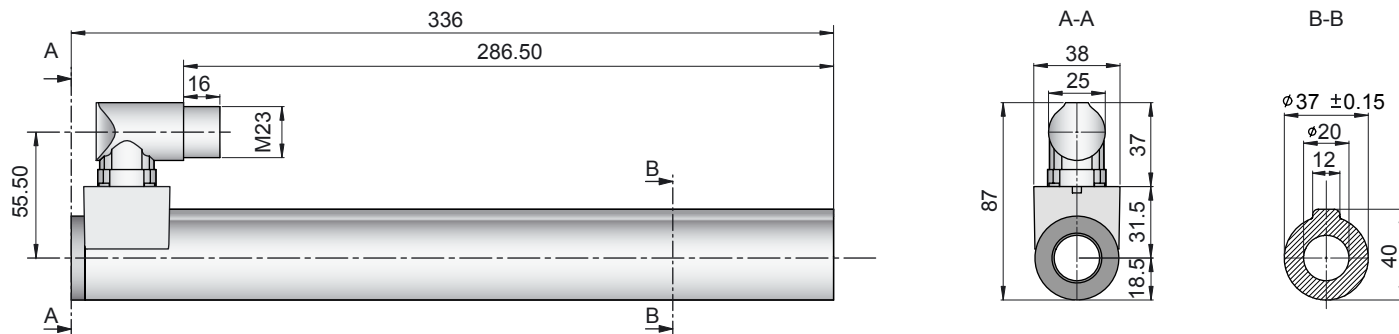

| Linearmotor | | Stator | | Läufer | |
|-----------------------|----------|----------------|-----------|--------|-----------------|
| Typ | Art. Nr. | Typ | Art. Nr. | Typ | Art. Nr. |
| P01-37x240/100x100-C | --> | PS01-37x240-C | 0150-1224 | & | PL01-20x305/160 |
| P01-37x240F/100x100-C | --> | PS01-37x240F-C | 0150-1225 | & | PL01-20x305/160 |
| | | | | | 0150-1311 |

Kabel Typ

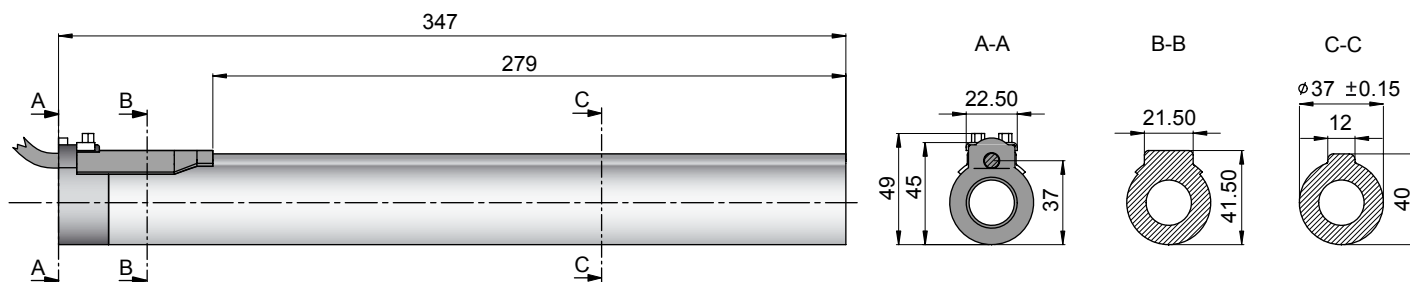

| Linearmotor | | Stator | | Läufer | |
|-------------------------|----------|------------------|-----------|--------|-----------------|
| Typ | Art. Nr. | Typ | Art. Nr. | Typ | Art. Nr. |
| P01-37x240/100x100 | --> | PS01-37x240 | 0150-1203 | & | PL01-20x305/160 |
| P01-37x240/100x100-C20 | --> | PS01-37x240-C20 | 0150-1238 | & | PL01-20x305/160 |
| P01-37x240F/100x100-C20 | --> | PS01-37x240F-C20 | 0150-1239 | & | PL01-20x305/160 |
| | | | | | 0150-1311 |

Läufer

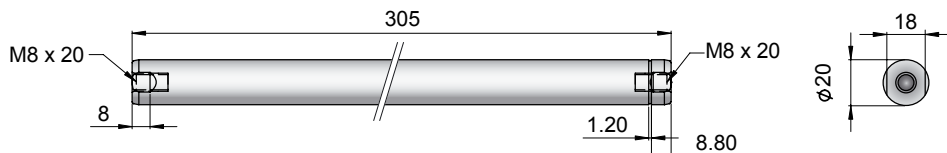

| Standard Läufer | | Standard Läufer | | PL01-20x305/160 | |
|-----------------|--|---|--|-------------------|-----------|
| Spezialläufer | | Heavy Duty Läufer mit WC/C-Beschichtung | | PL02-20x305/160 | |
| | | Lochläufer Innendurchmesser 6.5mm | | PL01-20x305/160-L | |
| | | High Clearance Läufer d=19mm, m=448g | | PL01-19x305/160 | |
| | | | | | 0150-1311 |
| | | | | | 0150-1314 |
| | | | | | 0150-1352 |
| | | | | | 0150-1450 |

Stecker

| Motor Steckerbelegung | | P01-37...-C | | P01-37...-C20 | | P01-37... | |
|-----------------------|----------------|-------------|----|---------------|--|-----------|--|
| Kabellänge: | | 1.5m | | 0.2m | | | |
| Ph 1+ | rot | A | 1 | | | | |
| Ph 1- | pink | B | 2 | | | | |
| Ph 2+ | blau | C | 3 | | | | |
| Ph 2- | grau | D | 4 | | | | |
| +5VDC | weiss | E | 5 | | | | |
| GND | innerer Schirm | F | 6 | | | | |
| Sinus | gelb | G | 7 | | | | |
| Cosinus | grün | H | 8 | | | | |
| Temp. | schwarz | L | 9 | | | | |
| Schirm | äusserer Schi. | Geh. | 10 | | | | |

Zubehör

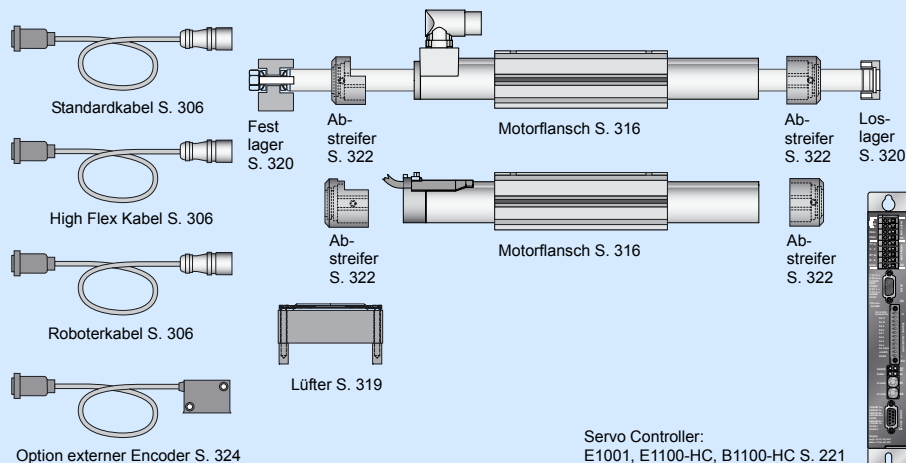

Maximaler Hub: 160mm
Spitzenkraft: 257N

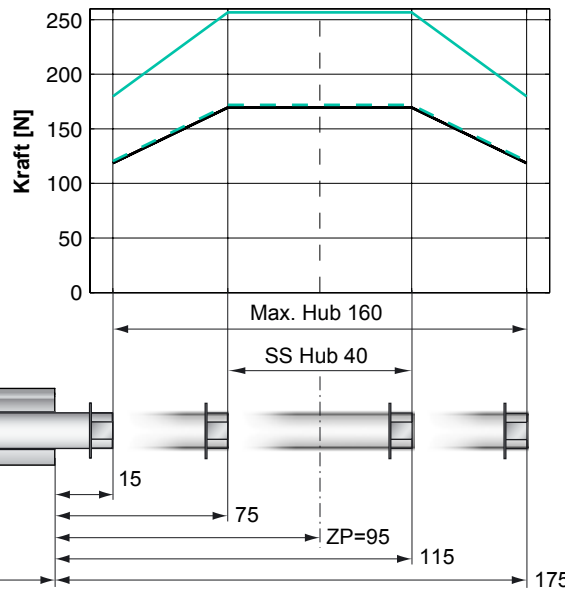

Standard Wicklung:
 — E1100-HC, 72VDC
 — E1100, 72VDC & E1001, 72VDC

F - Wicklung
 — E1100-HC, 72VDC
 - - E1100, 72VDC & E1001, 72VDC

Abmessungen mm
 *Kabel Typ

Motor Spezifikation

| | | Stecker Typ | | Kabel Typ | |
|----------------------------|-------------|-------------------|------------------|---------------------------------|--------------------|
| | | Standard Wicklung | F- Wicklung | Standard Wicklung | F- Wicklung |
| P01- 37x240/40x160-C | | 37x240/40x160-C | 37x240F/40x160-C | 37x240/40x160 37x240/40x160-C20 | 37x240F/40x160-C20 |
| Maximaler Hub | mm (in) | 160 (6.30) | 160 (6.30) | 160 (6.30) | 160 (6.30) |
| Kurzhubbereich SS | mm (in) | 40 (1.57) | 40 (1.57) | 40 (1.57) | 40 (1.57) |
| Spitzenkraft E1100-HC | N (lbf) | 169 (38.1) | 257 (57.7) | 169 (38.1) | 257 (57.7) |
| Spitzenkraft E1100 / E1001 | N (lbf) | 169 (38.1) | 172 (38.7) | 169 (38.1) | 172 (38.7) |
| Kont. Kraft | N (lbf) | 44 (10.0) | 44 (10.0) | 44 (10.0) | 44 (10.0) |
| Kont. Kraft mit Lüfter | N (lbf) | 83 (18.7) | 83 (18.7) | 83 (18.7) | 83 (18.7) |
| Randkraft | % | 70 | 70 | 70 | 70 |
| Kraftkonstante | N/A (lbf/A) | 34.0 (7.64) | 21.5 (4.83) | 34.0 (7.64) | 21.5 (4.83) |
| Max. Strom @ 72VDC | A | 5.0 | 11.9 | 5.0 | 11.9 |
| Max. Strom @ 48VDC | A | 3.3 | 8.0 | 3.3 | 8.0 |
| Max. Gesch. @ 72VDC | m/s (in/s) | 1.9 (77) | 3.1 (121) | 1.9 (77) | 3.1 (121) |
| Max. Gesch. @ 48VDC | m/s (in/s) | 1.3 (51) | 2.1 (81) | 1.3 (51) | 2.1 (81) |
| Phasenwider. 25/80 °C | Ohm | 11.7/14.2 | 4.9/5.9 | 11.7/14.2 | 4.9/5.9 |
| Phaseninduktivität | mH | 6.0 | 2.4 | 6.0 | 2.4 |
| Therm. Widerstand | °K/W | 2.3 | 2.2 | 2.3 | 2.2 |
| Therm. Zeitkonstante | sec | 3400 | 3200 | 3400 | 3200 |
| Statordurchmesser | mm (in) | 37 (1.46) | 37 (1.46) | 37 (1.46) | 37 (1.46) |
| Statorlänge | mm (in) | 336 (13.23) | 336 (13.23) | 347 (13.66) | 347 (13.66) |
| Statormasse | g (lb) | 1385 (3.05) | 1385 (3.05) | 1385 (3.05) | 1385 (3.05) |
| Läuferdurchmesser | mm (in) | 20 (0.79) | 20 (0.79) | 20 (0.79) | 20 (0.79) |
| Läuferlänge | mm (in) | 365 (14.37) | 365 (14.37) | 365 (14.37) | 365 (14.37) |
| Läufermasse | g (lb) | 635 (1.40) | 635 (1.40) | 635 (1.40) | 635 (1.40) |
| Wiederholgenauigkeit | mm (in) | ±0.05 (±0.0020) | ±0.05 (±0.0020) | ±0.05 (±0.0020) | ±0.05 (±0.0020) |
| Linearität | % | ±0.30 | ±0.30 | ±0.30 | ±0.30 |
| Wiederholgenauigk. ES | mm (in) | ±0.01 (±0.0004) | ±0.01 (±0.0004) | ±0.01 (±0.0004) | ±0.01 (±0.0004) |
| Linearität ES | mm (in) | ±0.01 (±0.0004) | ±0.01 (±0.0004) | ±0.01 (±0.0004) | ±0.01 (±0.0004) |

Hub-Zeit Diagramm

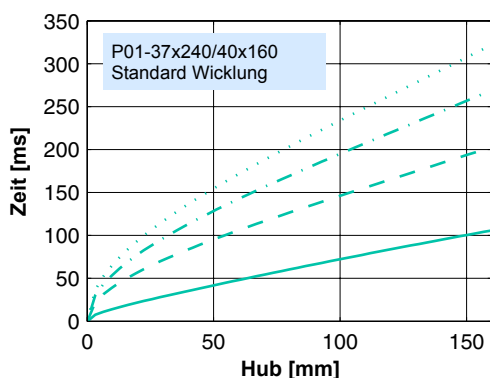

15.0 kg
 10.0 kg
 5.0 kg
 0.0 kg

Bewegter Läufer

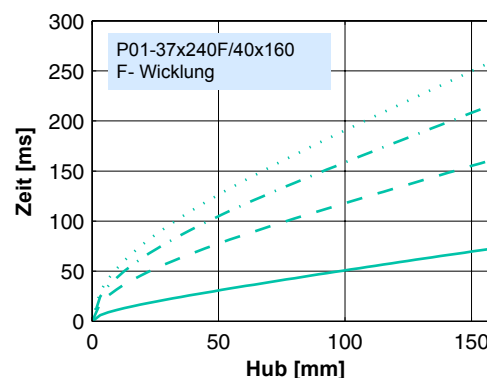

15.0 kg
 10.0 kg
 5.0 kg
 0.0 kg

Bewegter Läufer

Stecker Typ

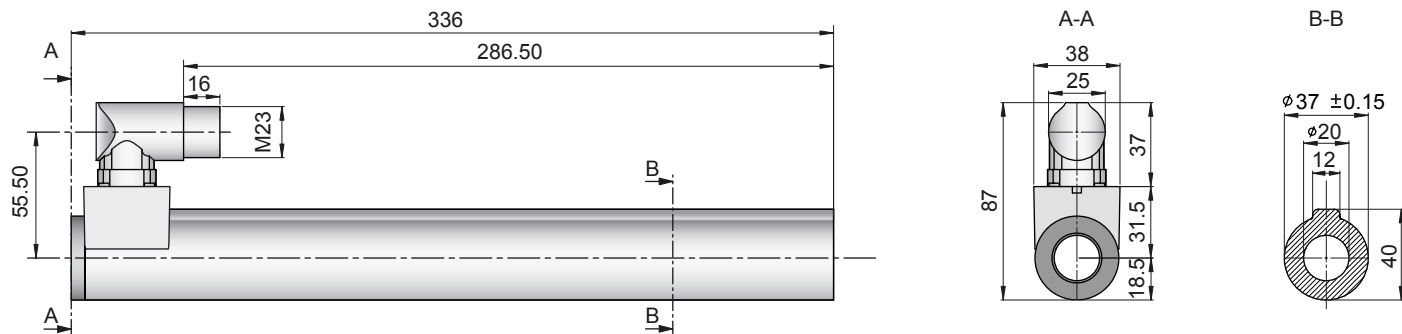

| Linearmotor | | Stator | | Läufer | |
|----------------------|----------|----------------|-----------|--------|-----------------|
| Typ | Art. Nr. | Typ | Art. Nr. | Typ | Art. Nr. |
| P01-37x240/40x160-C | --> | PS01-37x240-C | 0150-1224 | & | PL01-20x365/220 |
| P01-37x240F/40x160-C | --> | PS01-37x240F-C | 0150-1225 | & | PL01-20x365/220 |
| | | | | | 0150-1312 |

Kabel Typ

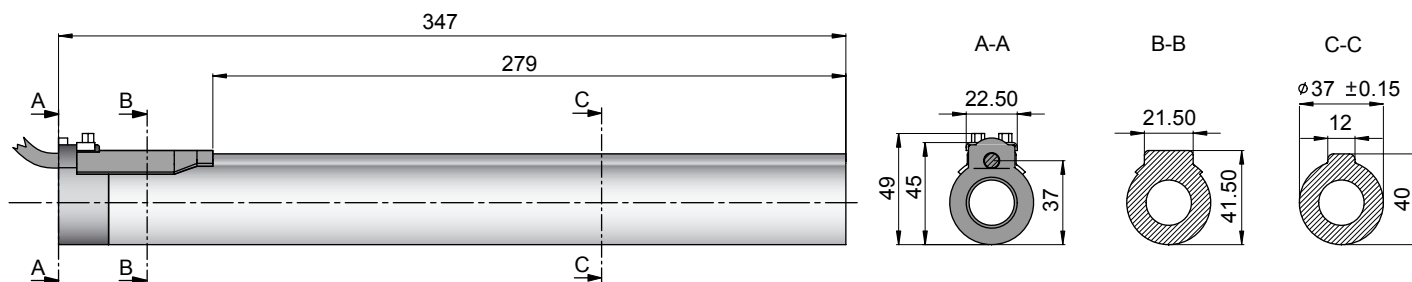

| Linearmotor | | Stator | | Läufer | |
|------------------------|----------|------------------|-----------|--------|-----------------|
| Typ | Art. Nr. | Typ | Art. Nr. | Typ | Art. Nr. |
| P01-37x240/40x160 | --> | PS01-37x240 | 0150-1203 | & | PL01-20x365/220 |
| P01-37x240/40x160-C20 | --> | PS01-37x240-C20 | 0150-1238 | & | PL01-20x365/220 |
| P01-37x240F/40x160-C20 | --> | PS01-37x240F-C20 | 0150-1239 | & | PL01-20x365/220 |
| | | | | | 0150-1312 |

Läufer

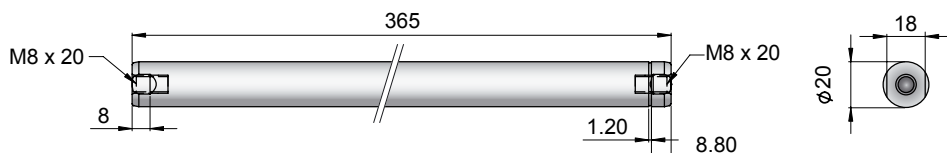

| Standard Läufer | | Standard Läufer | | PL01-20x365/220 | |
|-----------------|--|---|--|-------------------|-----------|
| Spezialläufer | | Heavy Duty Läufer mit WC/C-Beschichtung | | PL02-20x365/220 | |
| | | Lochläufer Innendurchmesser 6.5mm | | PL01-20x365/220-L | |
| | | High Clearance Läufer d=19mm, m=573g | | PL01-19x365/220 | |
| | | | | | 0150-1451 |

Stecker

| Motor Steckerbelegung | | P01-37...-C | | P01-37...-C20 | | P01-37... | |
|-----------------------|----------------|-------------|----|---------------|--|-----------|--|
| Kabellänge: | | 1.5m | | 0.2m | | | |
| Ph 1+ | rot | A | 1 | | | | |
| Ph 1- | pink | B | 2 | | | | |
| Ph 2+ | blau | C | 3 | | | | |
| Ph 2- | grau | D | 4 | | | | |
| +5VDC | weiss | E | 5 | | | | |
| GND | innerer Schirm | F | 6 | | | | |
| Sinus | gelb | G | 7 | | | | |
| Cosinus | grün | H | 8 | | | | |
| Temp. | schwarz | L | 9 | | | | |
| Schirm | äusserer Schi. | Geh. | 10 | | | | |

Zubehör

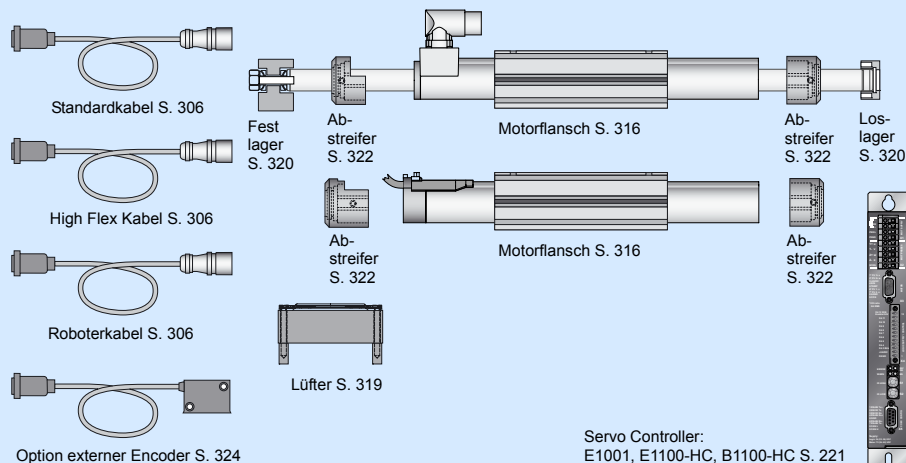

Maximaler Hub: 260mm
Spitzenkraft: 308N

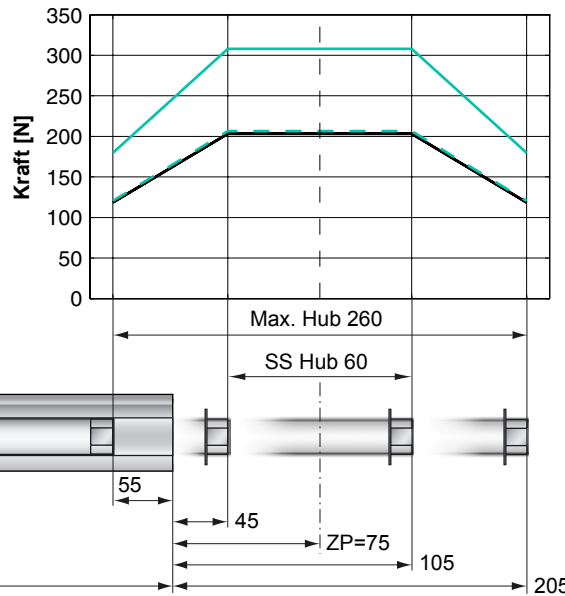

Standard Wicklung:
 — E1100-HC, 72VDC
 — E1100, 72VDC & E1001, 72VDC

F - Wicklung
 — E1100-HC, 72VDC
 - - E1100, 72VDC & E1001, 72VDC

Abmessungen mm
 *Kabel Typ

Motor Spezifikation

| | | Stecker Typ | | Kabel Typ | |
|----------------------------|-------------|--------------------------------------|---------------------------------|--|-----------------------------------|
| | | Standard Wicklung 37x240/60x260-C | F- Wicklung 37x240F/60x260-C | Standard Wicklung 37x240/60x260-C20 | F- Wicklung 37x240F/60x260-C20 |
| Maximaler Hub | mm (in) | 260 (10.24) | 260 (10.24) | 260 (10.24) | 260 (10.24) |
| Kurzhubbereich SS | mm (in) | 60 (2.36) | 60 (2.36) | 60 (2.36) | 60 (2.36) |
| Spitzenkraft E1100-HC | N (lbf) | 203 (45.7) | 308 (69.2) | 203 (45.7) | 308 (69.2) |
| Spitzenkraft E1100 / E1001 | N (lbf) | 203 (45.7) | 206 (46.4) | 203 (45.7) | 206 (46.4) |
| Kont. Kraft | N (lbf) | 53 (12.0) | 53 (12.0) | 53 (12.0) | 53 (12.0) |
| Kont. Kraft mit Lüfter | N (lbf) | 100 (22.4) | 100 (22.4) | 100 (22.4) | 100 (22.4) |
| Randkraft | % | 58 | 58 | 58 | 58 |
| Kraftkonstante | N/A (lbf/A) | 40.8 (9.17) | 25.8 (5.80) | 40.8 (9.17) | 25.8 (5.80) |
| Max. Strom @ 72VDC | A | 5.0 | 11.9 | 5.0 | 11.9 |
| Max. Strom @ 48VDC | A | 3.3 | 8.0 | 3.3 | 8.0 |
| Max. Gesch. @ 72VDC | m/s (in/s) | 1.6 (64) | 2.6 (101) | 1.6 (64) | 2.6 (101) |
| Max. Gesch. @ 48VDC | m/s (in/s) | 1.1 (43) | 1.7 (67) | 1.1 (43) | 1.7 (67) |
| Phasenwider. 25/80 °C | Ohm | 11.7/14.2 | 4.9/5.9 | 11.7/14.2 | 4.9/5.9 |
| Phaseninduktivität | mH | 6.0 | 2.4 | 6.0 | 2.4 |
| Therm. Widerstand | °K/W | 2.3 | 2.2 | 2.3 | 2.2 |
| Therm. Zeitkonstante | sec | 3400 | 3200 | 3400 | 3200 |
| Statordurchmesser | mm (in) | 37 (1.46) | 37 (1.46) | 37 (1.46) | 37 (1.46) |
| Statorlänge | mm (in) | 336 (13.23) | 336 (13.23) | 347 (13.66) | 347 (13.66) |
| Statormasse | g (lb) | 1385 (3.05) | 1385 (3.05) | 1385 (3.05) | 1385 (3.05) |
| Läuferdurchmesser | mm (in) | 20 (0.79) | 20 (0.79) | 20 (0.79) | 20 (0.79) |
| Läuferlänge | mm (in) | 395 (15.55) | 395 (15.55) | 395 (15.55) | 395 (15.55) |
| Läufermasse | g (lb) | 829 (1.83) | 829 (1.83) | 829 (1.83) | 829 (1.83) |
| Wiederholgenauigkeit | mm (in) | ±0.05 (±0.0020) | ±0.05 (±0.0020) | ±0.05 (±0.0020) | ±0.05 (±0.0020) |
| Linearität | % | ±0.20 | ±0.20 | ±0.20 | ±0.20 |
| Wiederholgenauigk. ES | mm (in) | ±0.01 (±0.0004) | ±0.01 (±0.0004) | ±0.01 (±0.0004) | ±0.01 (±0.0004) |
| Linearität ES | mm (in) | ±0.01 (±0.0004) | ±0.01 (±0.0004) | ±0.01 (±0.0004) | ±0.01 (±0.0004) |

Hub-Zeit Diagramm

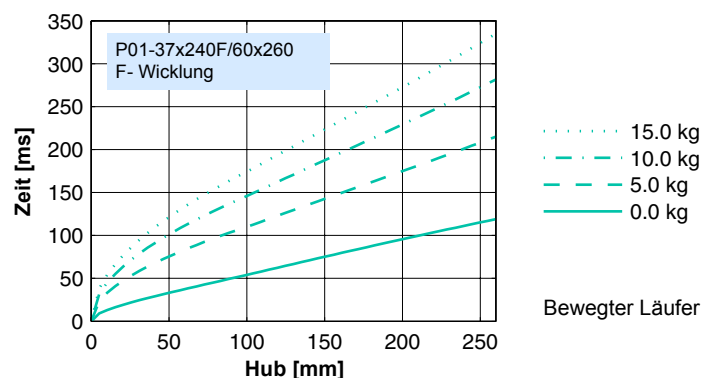
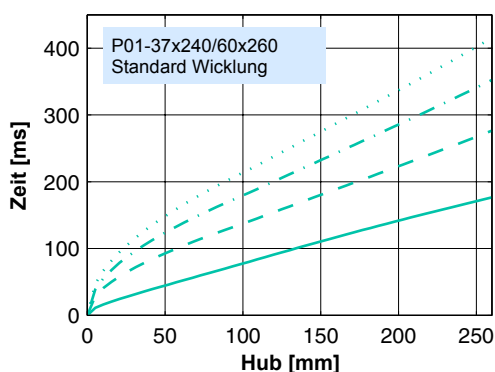

Stecker Typ

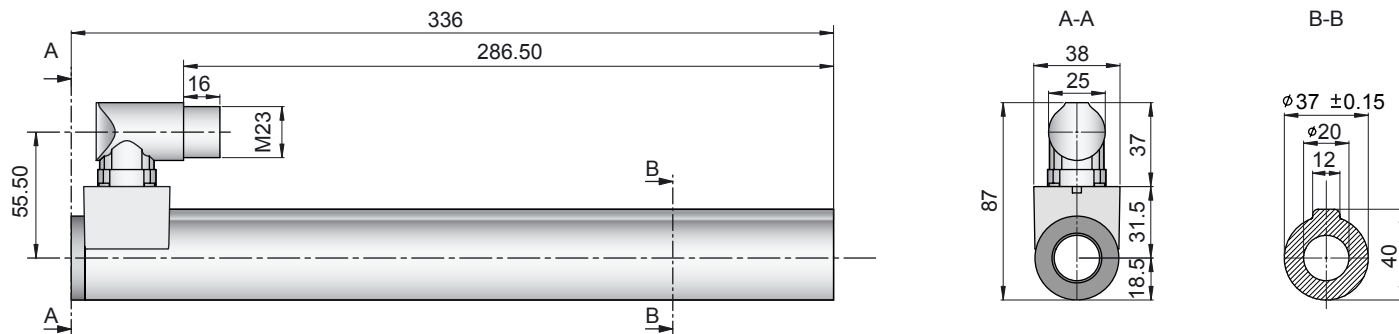

| Linearmotor | | Stator | | Läufer | |
|----------------------|----------|----------------|-----------|--------|-----------------|
| Typ | Art. Nr. | Typ | Art. Nr. | Typ | Art. Nr. |
| P01-37x240/60x260-C | --> | PS01-37x240-C | 0150-1224 | & | PL01-20x395/320 |
| P01-37x240F/60x260-C | --> | PS01-37x240F-C | 0150-1225 | & | PL01-20x395/320 |
| | | | | | 0150-1318 |

Kabel Typ

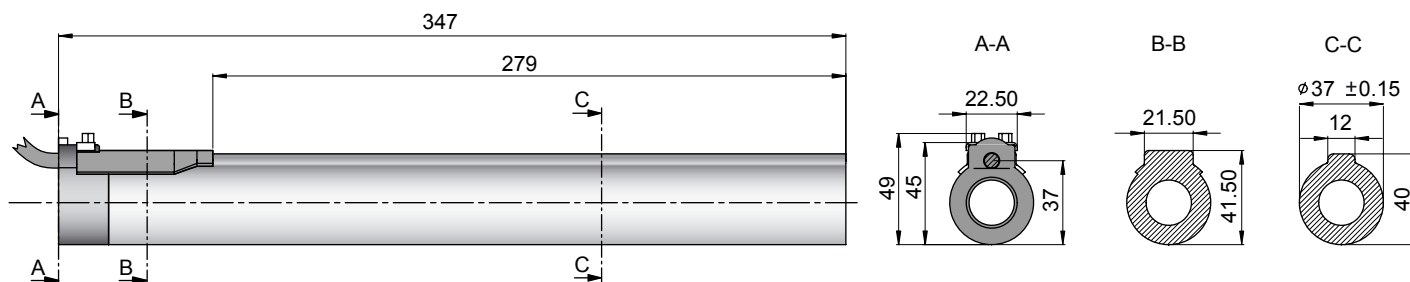

| Linearmotor | | Stator | | Läufer | |
|------------------------|----------|------------------|-----------|--------|-----------------|
| Typ | Art. Nr. | Typ | Art. Nr. | Typ | Art. Nr. |
| P01-37x240/60x260 | --> | PS01-37x240 | 0150-1203 | & | PL01-20x395/320 |
| P01-37x240/60x260-C20 | --> | PS01-37x240-C20 | 0150-1238 | & | PL01-20x395/320 |
| P01-37x240F/60x260-C20 | --> | PS01-37x240F-C20 | 0150-1239 | & | PL01-20x395/320 |
| | | | | | 0150-1318 |

Läufer

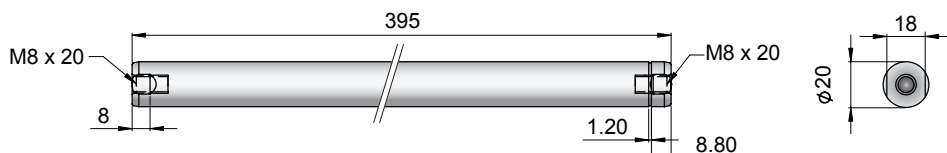

| Standard Läufer | | Standard Läufer | | PL01-20x395/320 | |
|-----------------|--|---|--|-------------------|-----------|
| Spezialläufer | | Heavy Duty Läufer mit WC/C-Beschichtung | | PL02-20x395/320 | |
| | | Lochläufer Innendurchmesser 6.5mm | | PL01-20x395/320-L | |
| | | High Clearance Läufer d=19mm, m=748g | | PL01-19x395/320 | |
| | | | | | 0150-1452 |

Stecker

| Motor Steckerbelegung | | P01-37...-C | | P01-37...-C20 | |
|-----------------------|----------------|-------------|----|---------------|--|
| Kabellänge: | | 1.5m | | 0.2m | |
| Ph 1+ | rot | A | 1 | | |
| Ph 1- | pink | B | 2 | | |
| Ph 2+ | blau | C | 3 | | |
| Ph 2- | grau | D | 4 | | |
| +5VDC | weiss | E | 5 | | |
| GND | innerer Schirm | F | 6 | | |
| Sinus | gelb | G | 7 | | |
| Cosinus | grün | H | 8 | | |
| Temp. | schwarz | L | 9 | | |
| Schirm | äusserer Schi. | Geh. | 10 | | |

Zubehör

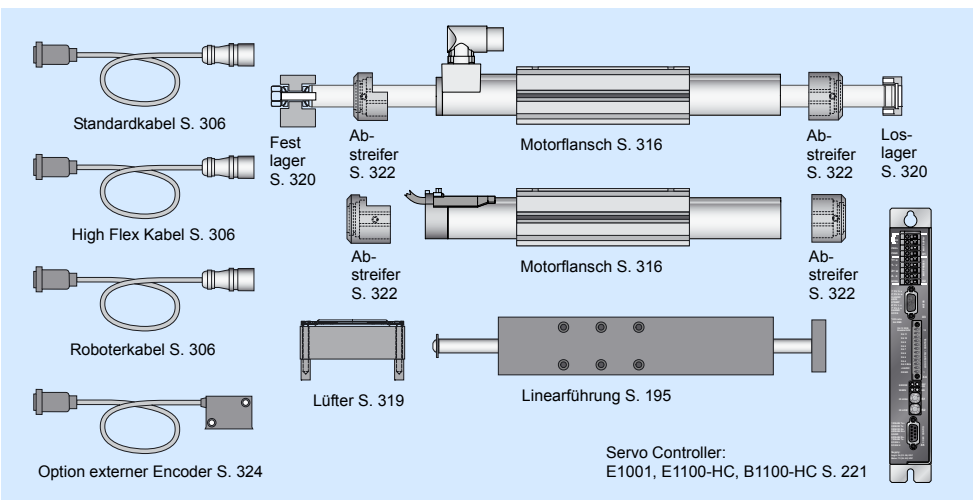

Maximaler Hub: 360mm
Spitzenkraft: 308N

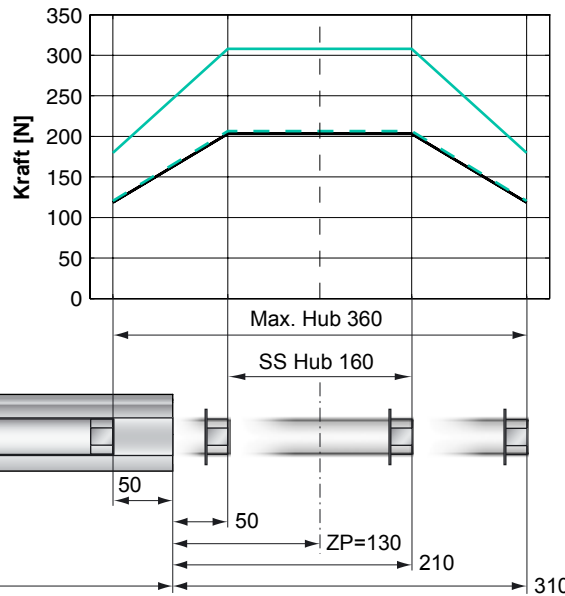

Standard Wicklung:
 — E1100-HC, 72VDC
 - - E1100, 72VDC & E1001, 72VDC

F - Wicklung
 — E1100-HC, 72VDC
 - - E1100, 72VDC & E1001, 72VDC

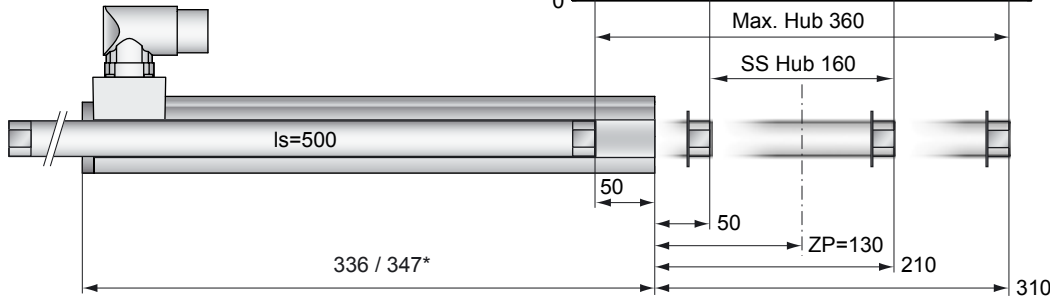

Abmessungen mm
 *Kabel Typ

Motor Spezifikation

| | | Stecker Typ | | Kabel Typ | |
|----------------------------|-------------|-------------------|-------------------|--------------------|---------------------|
| | | Standard Wicklung | F- Wicklung | Standard Wicklung | F- Wicklung |
| P01- | | 37x240/160x360-C | 37x240F/160x360-C | 37x240/160x360-C20 | 37x240F/160x360-C20 |
| Maximaler Hub | mm (in) | 360 (14.17) | 360 (14.17) | 360 (14.17) | 360 (14.17) |
| Kurzhubbereich SS | mm (in) | 160 (6.30) | 160 (6.30) | 160 (6.30) | 160 (6.30) |
| Spitzenkraft E1100-HC | N (lbf) | 203 (45.7) | 308 (69.2) | 203 (45.7) | 308 (69.2) |
| Spitzenkraft E1100 / E1001 | N (lbf) | 203 (45.7) | 206 (46.4) | 203 (45.7) | 206 (46.4) |
| Kont. Kraft | N (lbf) | 53 (12.0) | 53 (12.0) | 53 (12.0) | 53 (12.0) |
| Kont. Kraft mit Lüfter | N (lbf) | 100 (22.4) | 100 (22.4) | 100 (22.4) | 100 (22.4) |
| Randkraft | % | 58 | 58 | 58 | 58 |
| Kraftkonstante | N/A (lbf/A) | 40.8 (9.17) | 25.8 (5.80) | 40.8 (9.17) | 25.8 (5.80) |
| Max. Strom @ 72VDC | A | 5.0 | 11.9 | 5.0 | 11.9 |
| Max. Strom @ 48VDC | A | 3.3 | 8.0 | 3.3 | 8.0 |
| Max. Gesch. @ 72VDC | m/s (in/s) | 1.6 (64) | 2.6 (101) | 1.6 (64) | 2.6 (101) |
| Max. Gesch. @ 48VDC | m/s (in/s) | 1.1 (43) | 1.7 (67) | 1.1 (43) | 1.7 (67) |
| Phasenwider. 25/80 °C | Ohm | 11.7/14.2 | 4.9/5.9 | 11.7/14.2 | 4.9/5.9 |
| Phaseninduktivität | mH | 6.0 | 2.4 | 6.0 | 2.4 |
| Therm. Widerstand | °K/W | 2.3 | 2.2 | 2.3 | 2.2 |
| Therm. Zeitkonstante | sec | 3400 | 3200 | 3400 | 3200 |
| Statordurchmesser | mm (in) | 37 (1.46) | 37 (1.46) | 37 (1.46) | 37 (1.46) |
| Statorlänge | mm (in) | 336 (13.23) | 336 (13.23) | 347 (13.66) | 347 (13.66) |
| Statormasse | g (lb) | 1385 (3.05) | 1385 (3.05) | 1385 (3.05) | 1385 (3.05) |
| Läuferdurchmesser | mm (in) | 20 (0.79) | 20 (0.79) | 20 (0.79) | 20 (0.79) |
| Läuferlänge | mm (in) | 500 (19.69) | 500 (19.69) | 500 (19.69) | 500 (19.69) |
| Läufermasse | g (lb) | 1064 (2.35) | 1064 (2.35) | 1064 (2.35) | 1064 (2.35) |
| Wiederholgenauigkeit | mm (in) | ±0.05 (±0.0020) | ±0.05 (±0.0020) | ±0.05 (±0.0020) | ±0.05 (±0.0020) |
| Linearität | % | ±0.20 | ±0.20 | ±0.20 | ±0.20 |
| Wiederholgenauigk. ES | mm (in) | ±0.01 (±0.0004) | ±0.01 (±0.0004) | ±0.01 (±0.0004) | ±0.01 (±0.0004) |
| Linearität ES | mm (in) | ±0.01 (±0.0004) | ±0.01 (±0.0004) | ±0.01 (±0.0004) | ±0.01 (±0.0004) |

Hub-Zeit Diagramm

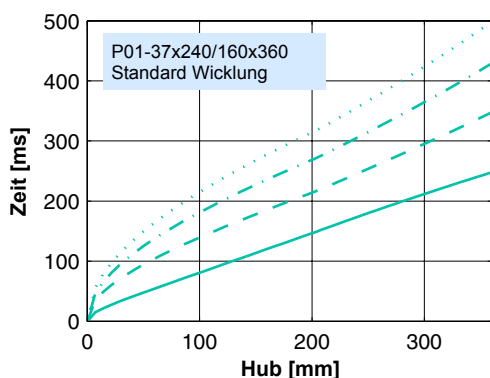

15.0 kg
 10.0 kg
 5.0 kg
 0.0 kg

Bewegter Läufer

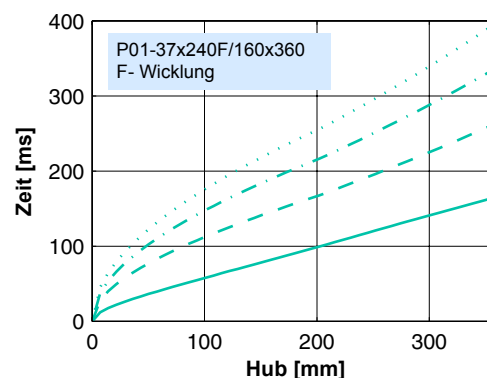

15.0 kg
 10.0 kg
 5.0 kg
 0.0 kg

Bewegter Läufer

Stecker Typ

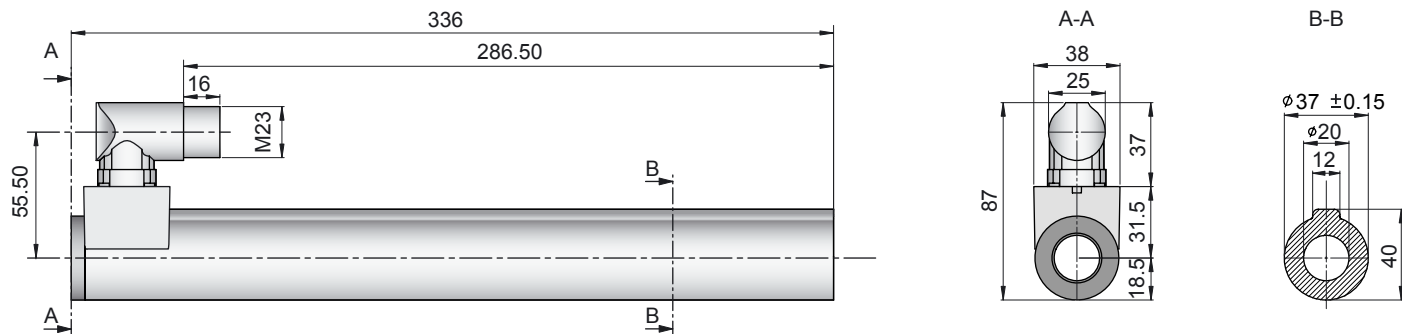

| Linearmotor | | Stator | | | Läufer | |
|-----------------------|----------|----------------|-----------|---|-----------------|-----------|
| Typ | Art. Nr. | Typ | Art. Nr. | | Typ | Art. Nr. |
| P01-37x240/160x360-C | --> | PS01-37x240-C | 0150-1224 | & | PL01-20x500/420 | 0150-1328 |
| P01-37x240F/160x360-C | --> | PS01-37x240F-C | 0150-1225 | & | PL01-20x500/420 | 0150-1328 |

Kabel Typ

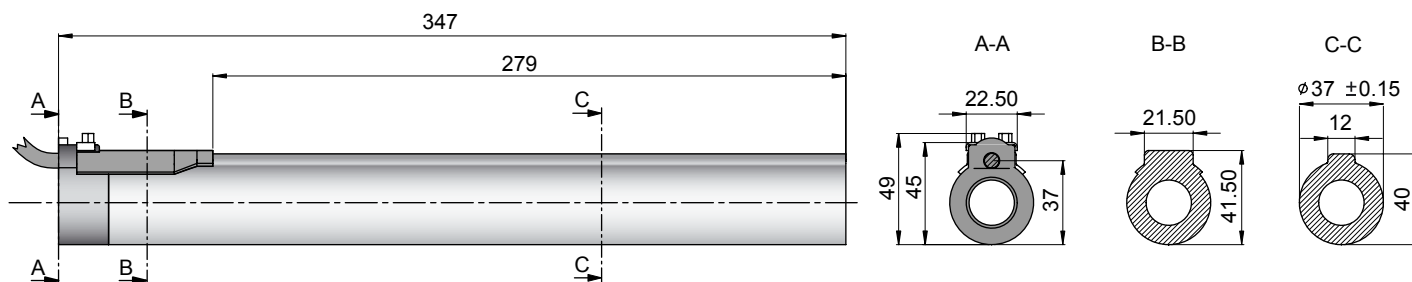

| Linearmotor | | Stator | | | Läufer | |
|-------------------------|----------|------------------|-----------|---|-----------------|-----------|
| Typ | Art. Nr. | Typ | Art. Nr. | | Typ | Art. Nr. |
| P01-37x240/160x360 | --> | PS01-37x240 | 0150-1203 | & | PL01-20x500/420 | 0150-1328 |
| P01-37x240/160x360-C20 | --> | PS01-37x240-C20 | 0150-1238 | & | PL01-20x500/420 | 0150-1328 |
| P01-37x240F/160x360-C20 | --> | PS01-37x240F-C20 | 0150-1239 | & | PL01-20x500/420 | 0150-1328 |

Läufer

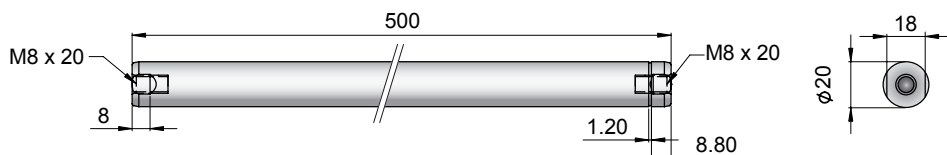

| Standard Läufer | | Standard Läufer | | PL01-20x500/420 | |
|-----------------|--|---|--|-------------------|--|
| Spezialläufer | | Heavy Duty Läufer mit WC/C-Beschichtung | | PL02-20x500/420 | |
| | | Lochläufer Innendurchmesser 6.5mm | | PL01-20x500/420-L | |
| | | High Clearance Läufer d=19mm, m=960g | | PL01-19x500/420 | |
| | | | | | |

Stecker

Motor Steckerbelegung

Kabellänge:
P01-37x240... 1.5m
P01-37x240...-C20 0.2m

| Ph 1+ | Ph 1- | Ph 2+ | Ph 2- | +5VDC | GND | Sinus | Cosinus | Temp. | Schirm |
|-------|-------|-------|-------|-------|----------------|-------|---------|---------|----------------|
| rot | pink | blau | grau | weiss | innerer Schirm | gelb | grün | schwarz | äusserer Schi. |
| A | B | C | D | E | F | G | H | L | Geh. |
| 1 | 2 | 3 | 4 | 5 | 6 | 7 | 8 | 9 | 10 |

Zubehör

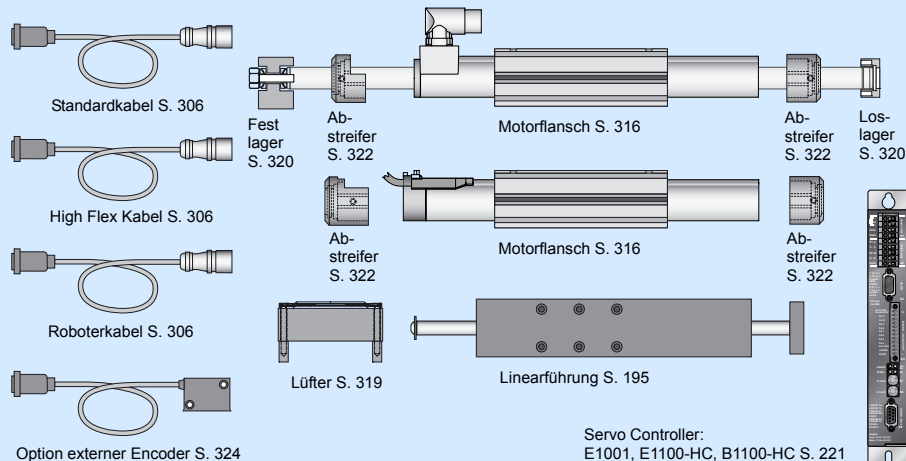

Maximaler Hub: 460mm
Spitzenkraft: 308N

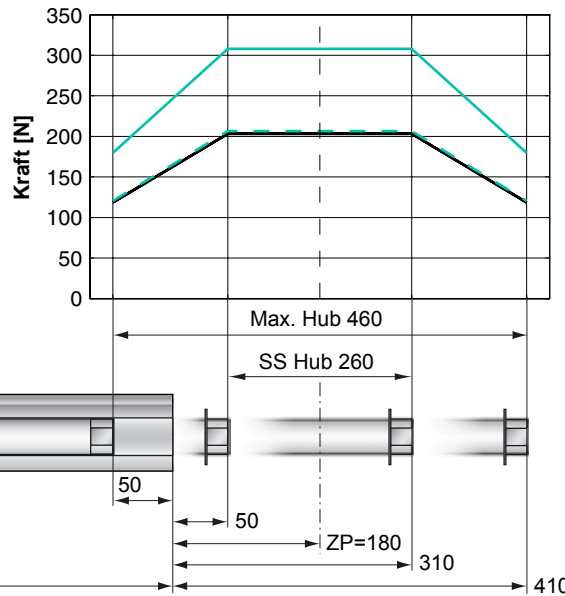

Standard Wicklung:
 — E1100-HC, 72VDC
 — E1100, 72VDC & E1001, 72VDC

F - Wicklung
 - - E1100-HC, 72VDC
 - - E1100, 72VDC & E1001, 72VDC

Abmessungen mm
 *Kabel Typ

Motor Spezifikation

| P01- | | Stecker Typ | | Kabel Typ | |
|----------------------------|-------------|-------------------|-------------------|--------------------------------------|---------------------|
| | | Standard Wicklung | F- Wicklung | Standard Wicklung | F- Wicklung |
| | | 37x240/260x460-C | 37x240F/260x460-C | 37x240/260x460 37x240/260x460-C20 | 37x240F/260x460-C20 |
| Maximaler Hub | mm (in) | 460 (18.11) | 460 (18.11) | 460 (18.11) | 460 (18.11) |
| Kurzhubbereich SS | mm (in) | 260 (10.24) | 260 (10.24) | 260 (10.24) | 260 (10.24) |
| Spitzenkraft E1100-HC | N (lbf) | 203 (45.7) | 308 (69.2) | 203 (45.7) | 308 (69.2) |
| Spitzenkraft E1100 / E1001 | N (lbf) | 203 (45.7) | 206 (46.4) | 203 (45.7) | 206 (46.4) |
| Kont. Kraft | N (lbf) | 53 (12.0) | 53 (12.0) | 53 (12.0) | 53 (12.0) |
| Kont. Kraft mit Lüfter | N (lbf) | 100 (22.4) | 100 (22.4) | 100 (22.4) | 100 (22.4) |
| Randkraft | % | 58 | 58 | 58 | 58 |
| Kraftkonstante | N/A (lbf/A) | 40.8 (9.17) | 25.8 (5.80) | 40.8 (9.17) | 25.8 (5.80) |
| Max. Strom @ 72VDC | A | 5.0 | 11.9 | 5.0 | 11.9 |
| Max. Strom @ 48VDC | A | 3.3 | 8.0 | 3.3 | 8.0 |
| Max. Gesch. @ 72VDC | m/s (in/s) | 1.6 (64) | 2.6 (101) | 1.6 (64) | 2.6 (101) |
| Max. Gesch. @ 48VDC | m/s (in/s) | 1.1 (43) | 1.7 (67) | 1.1 (43) | 1.7 (67) |
| Phasenwider. 25/80 °C | Ohm | 11.7/14.2 | 4.9/5.9 | 11.7/14.2 | 4.9/5.9 |
| Phaseninduktivität | mH | 6.0 | 2.4 | 6.0 | 2.4 |
| Therm. Widerstand | °K/W | 2.3 | 2.2 | 2.3 | 2.2 |
| Therm. Zeitkonstante | sec | 3400 | 3200 | 3400 | 3200 |
| Statordurchmesser | mm (in) | 37 (1.46) | 37 (1.46) | 37 (1.46) | 37 (1.46) |
| Statorlänge | mm (in) | 336 (13.23) | 336 (13.23) | 347 (13.66) | 347 (13.66) |
| Statormasse | g (lb) | 1385 (3.05) | 1385 (3.05) | 1385 (3.05) | 1385 (3.05) |
| Läuferdurchmesser | mm (in) | 20 (0.79) | 20 (0.79) | 20 (0.79) | 20 (0.79) |
| Läuferlänge | mm (in) | 600 (23.62) | 600 (23.62) | 600 (23.62) | 600 (23.62) |
| Läufermasse | g (lb) | 1297 (2.86) | 1297 (2.86) | 1297 (2.86) | 1297 (2.86) |
| Wiederholgenauigkeit | mm (in) | ±0.05 (±0.0020) | ±0.05 (±0.0020) | ±0.05 (±0.0020) | ±0.05 (±0.0020) |
| Linearität | % | ±0.15 | ±0.15 | ±0.15 | ±0.15 |
| Wiederholgenauigk. ES | mm (in) | ±0.01 (±0.0004) | ±0.01 (±0.0004) | ±0.01 (±0.0004) | ±0.01 (±0.0004) |
| Linearität ES | mm (in) | ±0.01 (±0.0004) | ±0.01 (±0.0004) | ±0.01 (±0.0004) | ±0.01 (±0.0004) |

Hub-Zeit Diagramm

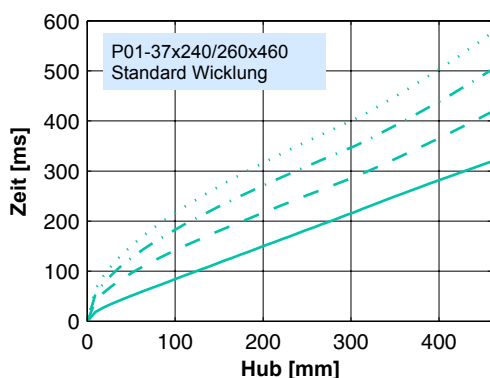

15.0 kg
 10.0 kg
 5.0 kg
 0.0 kg

Bewegter Läufer

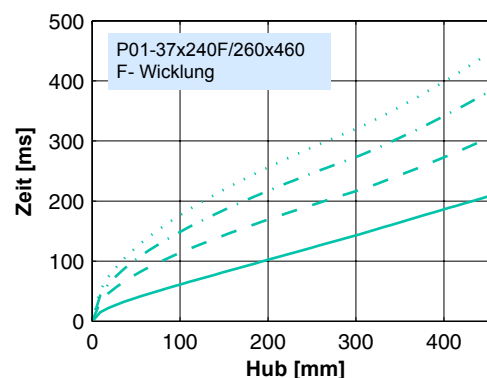

15.0 kg
 10.0 kg
 5.0 kg
 0.0 kg

Bewegter Läufer

Stecker Typ

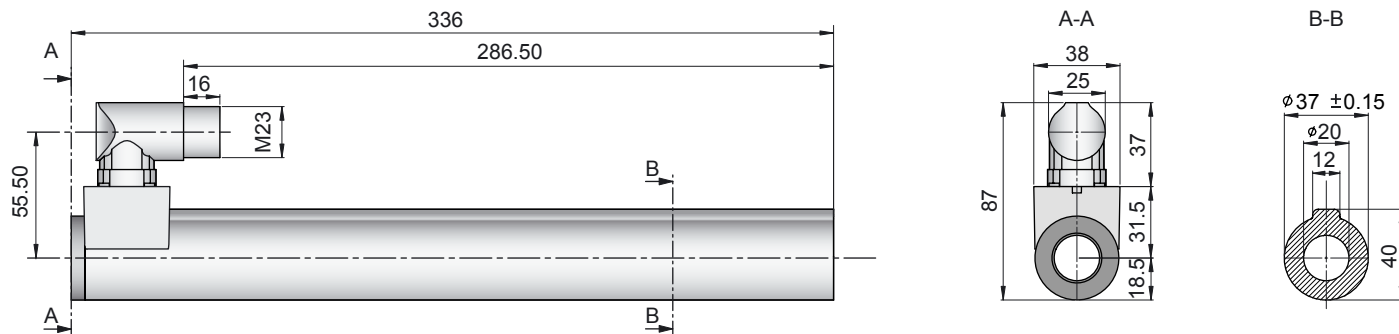

| Linearmotor | | Stator | | Läufer | |
|-----------------------|----------|----------------|-----------|--------|-----------------|
| Typ | Art. Nr. | Typ | Art. Nr. | Typ | Art. Nr. |
| P01-37x240/260x460-C | --> | PS01-37x240-C | 0150-1224 | & | PL01-20x600/520 |
| P01-37x240F/260x460-C | --> | PS01-37x240F-C | 0150-1225 | & | PL01-20x600/520 |
| | | | | | 0150-1330 |

Kabel Typ

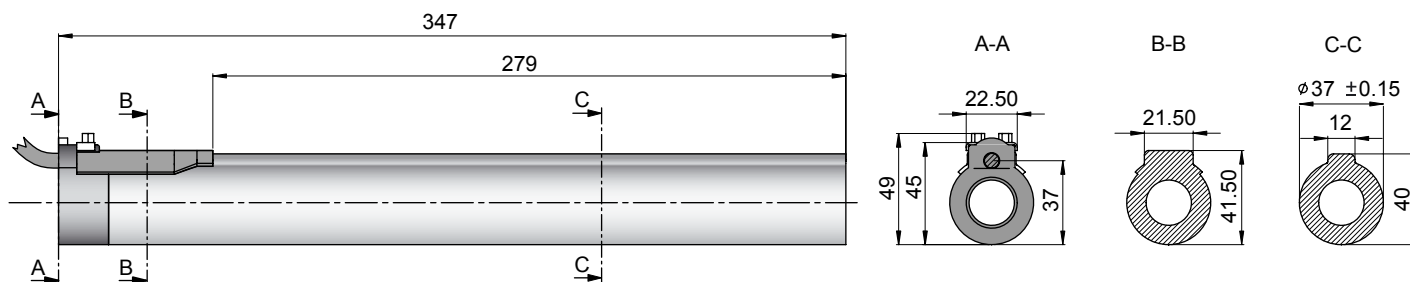

| Linearmotor | | Stator | | Läufer | |
|-------------------------|----------|------------------|-----------|--------|-----------------|
| Typ | Art. Nr. | Typ | Art. Nr. | Typ | Art. Nr. |
| P01-37x240/260x460 | --> | PS01-37x240 | 0150-1203 | & | PL01-20x600/520 |
| P01-37x240/260x460-C20 | --> | PS01-37x240-C20 | 0150-1238 | & | PL01-20x600/520 |
| P01-37x240F/260x460-C20 | --> | PS01-37x240F-C20 | 0150-1239 | & | PL01-20x600/520 |
| | | | | | 0150-1330 |

Läufer

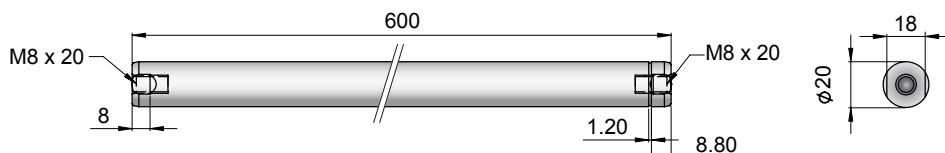

| Standard Läufer | | Standard Läufer | | PL01-20x600/520 | |
|-----------------|--|---|--|-------------------|-----------|
| Spezialläufer | | Heavy Duty Läufer mit WC/C-Beschichtung | | PL02-20x600/520 | |
| | | Lochläufer Innendurchmesser 6.5mm | | PL01-20x600/520-L | |
| | | High Clearance Läufer d=19mm, m=1171g | | PL01-19x600/520 | |
| | | | | | 0150-1456 |

Stecker

| Motor Steckerbelegung | | P01-37...-C | | P01-37...-C20 | | P01-37... | |
|-----------------------|----------------|-------------|----|---------------|--|-----------|--|
| Kabellänge: | | 1.5m | | 0.2m | | | |
| Ph 1+ | rot | A | 1 | | | | |
| Ph 1- | pink | B | 2 | | | | |
| Ph 2+ | blau | C | 3 | | | | |
| Ph 2- | grau | D | 4 | | | | |
| +5VDC | weiss | E | 5 | | | | |
| GND | innerer Schirm | F | 6 | | | | |
| Sinus | gelb | G | 7 | | | | |
| Cosinus | grün | H | 8 | | | | |
| Temp. | schwarz | L | 9 | | | | |
| Schirm | äusserer Schi. | Geh. | 10 | | | | |

Zubehör

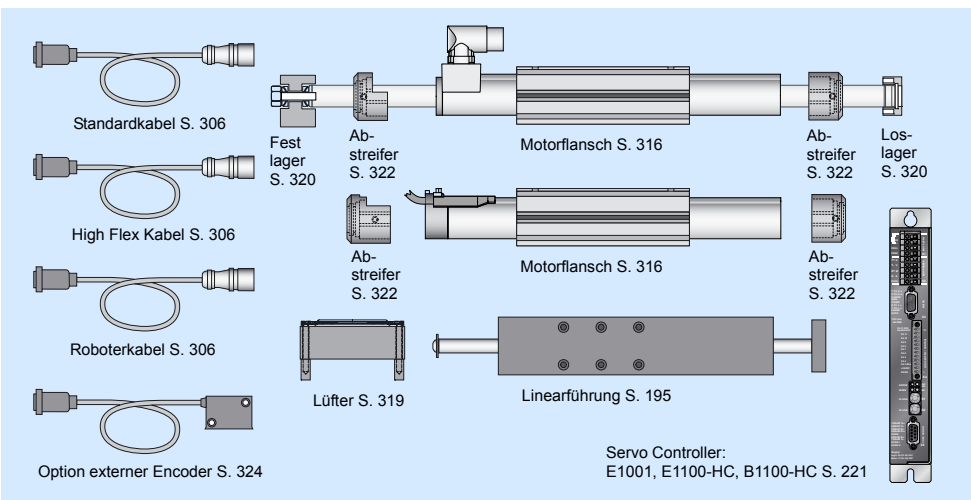

Maximaler Hub: 560mm
Spitzenkraft: 308N

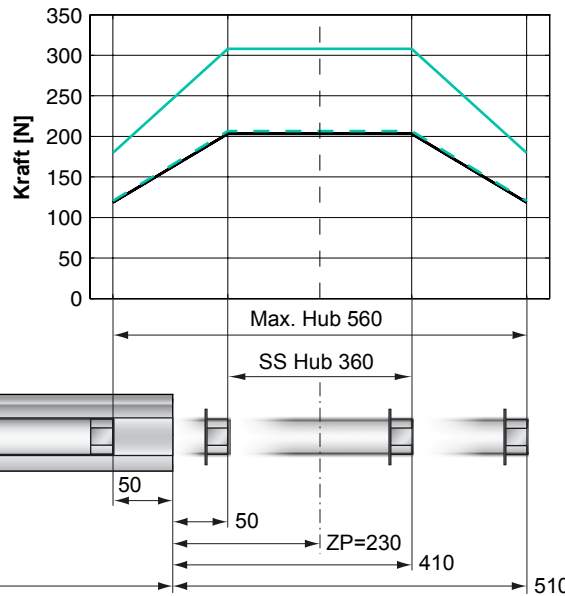

Standard Wicklung:
 — E1100-HC, 72VDC
 — E1100, 72VDC & E1001, 72VDC

F - Wicklung
 — E1100-HC, 72VDC
 - - E1100, 72VDC & E1001, 72VDC

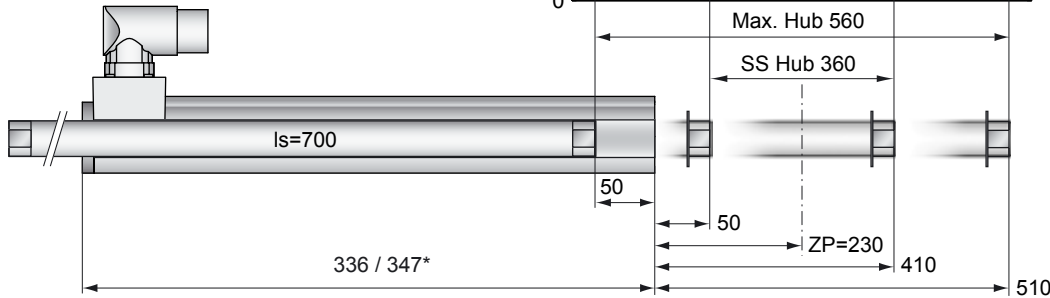

Abmessungen mm
 *Kabel Typ

Motor Spezifikation

| | | Stecker Typ | | Kabel Typ | |
|----------------------------|-------------|-------------------|-------------------|-------------------|---------------------|
| | | Standard Wicklung | F- Wicklung | Standard Wicklung | F- Wicklung |
| P01- | | 37x240/360x560-C | 37x240F/360x560-C | 37x240/360x560 | 37x240F/360x560-C20 |
| Maximaler Hub | mm (in) | 560 (22.05) | 560 (22.05) | 560 (22.05) | 560 (22.05) |
| Kurzhubbereich SS | mm (in) | 360 (14.17) | 360 (14.17) | 360 (14.17) | 360 (14.17) |
| Spitzenkraft E1100-HC | N (lbf) | 203 (45.7) | 308 (69.2) | 203 (45.7) | 308 (69.2) |
| Spitzenkraft E1100 / E1001 | N (lbf) | 203 (45.7) | 206 (46.4) | 203 (45.7) | 206 (46.4) |
| Kont. Kraft | N (lbf) | 53 (12.0) | 53 (12.0) | 53 (12.0) | 53 (12.0) |
| Kont. Kraft mit Lüfter | N (lbf) | 100 (22.4) | 100 (22.4) | 100 (22.4) | 100 (22.4) |
| Randkraft | % | 58 | 58 | 58 | 58 |
| Kraftkonstante | N/A (lbf/A) | 40.8 (9.17) | 25.8 (5.80) | 40.8 (9.17) | 25.8 (5.80) |
| Max. Strom @ 72VDC | A | 5.0 | 11.9 | 5.0 | 11.9 |
| Max. Strom @ 48VDC | A | 3.3 | 8.0 | 3.3 | 8.0 |
| Max. Gesch. @ 72VDC | m/s (in/s) | 1.6 (64) | 2.6 (101) | 1.6 (64) | 2.6 (101) |
| Max. Gesch. @ 48VDC | m/s (in/s) | 1.1 (43) | 1.7 (67) | 1.1 (43) | 1.7 (67) |
| Phasenwider. 25/80 °C | Ohm | 11.7/14.2 | 4.9/5.9 | 11.7/14.2 | 4.9/5.9 |
| Phaseninduktivität | mH | 6.0 | 2.4 | 6.0 | 2.4 |
| Therm. Widerstand | °K/W | 2.3 | 2.2 | 2.3 | 2.2 |
| Therm. Zeitkonstante | sec | 3400 | 3200 | 3400 | 3200 |
| Statordurchmesser | mm (in) | 37 (1.46) | 37 (1.46) | 37 (1.46) | 37 (1.46) |
| Statorlänge | mm (in) | 336 (13.23) | 336 (13.23) | 347 (13.66) | 347 (13.66) |
| Statormasse | g (lb) | 1385 (3.05) | 1385 (3.05) | 1385 (3.05) | 1385 (3.05) |
| Läuferdurchmesser | mm (in) | 20 (0.79) | 20 (0.79) | 20 (0.79) | 20 (0.79) |
| Läuferlänge | mm (in) | 700 (27.56) | 700 (27.56) | 700 (27.56) | 700 (27.56) |
| Läufermasse | g (lb) | 1529 (3.37) | 1529 (3.37) | 1529 (3.37) | 1529 (3.37) |
| Wiederholgenauigkeit | mm (in) | ±0.05 (±0.0020) | ±0.05 (±0.0020) | ±0.05 (±0.0020) | ±0.05 (±0.0020) |
| Linearität | % | ±0.15 | ±0.15 | ±0.15 | ±0.15 |
| Wiederholgenauigk. ES | mm (in) | ±0.01 (±0.0004) | ±0.01 (±0.0004) | ±0.01 (±0.0004) | ±0.01 (±0.0004) |
| Linearität ES | mm (in) | ±0.01 (±0.0004) | ±0.01 (±0.0004) | ±0.01 (±0.0004) | ±0.01 (±0.0004) |

Hub-Zeit Diagramm

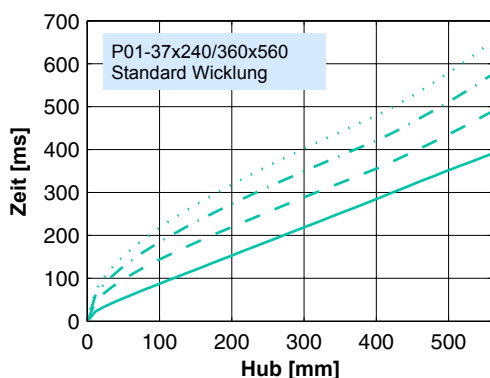

15.0 kg
 10.0 kg
 5.0 kg
 0.0 kg

Bewegter Läufer

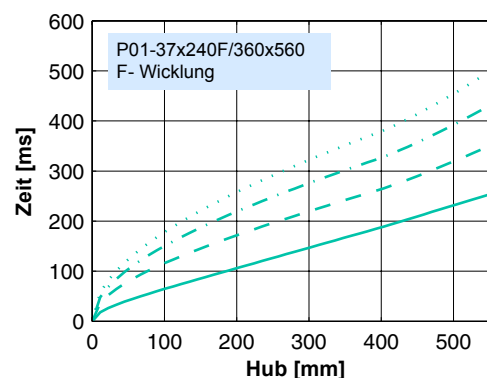

15.0 kg
 10.0 kg
 5.0 kg
 0.0 kg

Bewegter Läufer

Stecker Typ

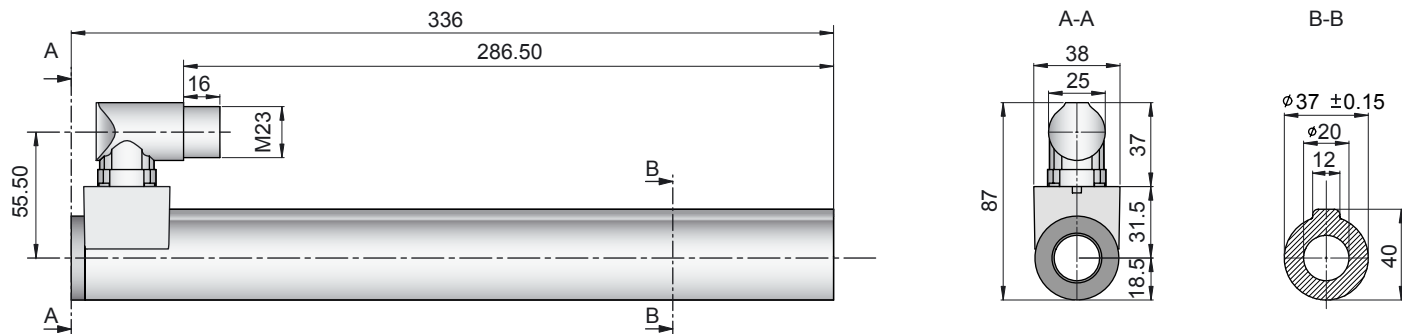

| Linearmotor | | Stator | | Läufer | |
|-----------------------|----------|----------------|-----------|--------|-----------------|
| Typ | Art. Nr. | Typ | Art. Nr. | Typ | Art. Nr. |
| P01-37x240/360x560-C | --> | PS01-37x240-C | 0150-1224 | & | PL01-20x700/620 |
| P01-37x240F/360x560-C | --> | PS01-37x240F-C | 0150-1225 | & | PL01-20x700/620 |
| | | | | | 0150-1332 |

Kabel Typ

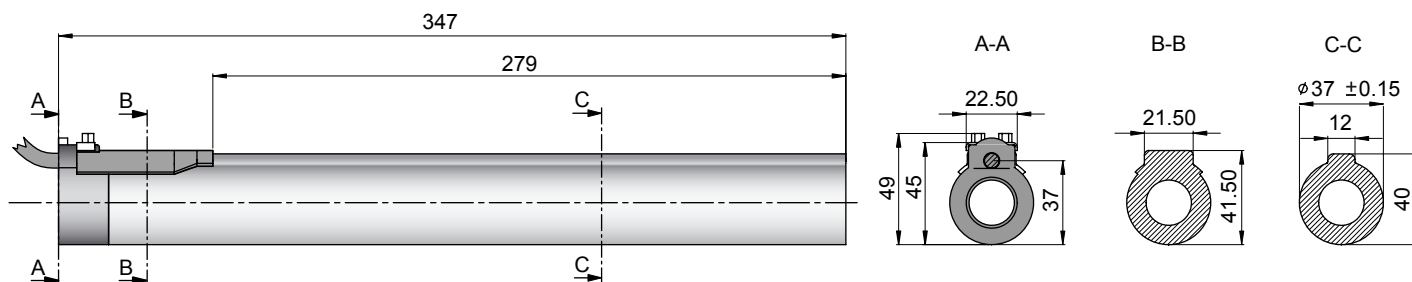

| Linearmotor | | Stator | | Läufer | |
|-------------------------|----------|------------------|-----------|--------|-----------------|
| Typ | Art. Nr. | Typ | Art. Nr. | Typ | Art. Nr. |
| P01-37x240/360x560 | --> | PS01-37x240 | 0150-1203 | & | PL01-20x700/620 |
| P01-37x240/360x560-C20 | --> | PS01-37x240-C20 | 0150-1238 | & | PL01-20x700/620 |
| P01-37x240F/360x560-C20 | --> | PS01-37x240F-C20 | 0150-1239 | & | PL01-20x700/620 |
| | | | | | 0150-1332 |

Läufer

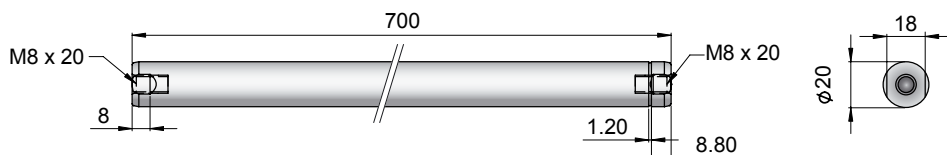

| Standard Läufer | | Standard Läufer | | PL01-20x700/620 | |
|-----------------|--|---|--|-------------------|-----------|
| Spezialläufer | | Heavy Duty Läufer mit WC/C-Beschichtung | | PL02-20x700/620 | |
| | | Lochläufer Innendurchmesser 6.5mm | | PL01-20x700/620-L | |
| | | High Clearance Läufer d=19mm, m=1380g | | PL01-19x700/620 | |
| | | | | | 0150-1457 |

Stecker

| Motor Steckerbelegung | | P01-37...-C | | P01-37...-C20 | | P01-37... | |
|-----------------------|----------------|-------------|----|---------------|--|-----------|--|
| Kabellänge: | | 1.5m | | 0.2m | | | |
| Ph 1+ | rot | A | 1 | | | | |
| Ph 1- | pink | B | 2 | | | | |
| Ph 2+ | blau | C | 3 | | | | |
| Ph 2- | grau | D | 4 | | | | |
| +5VDC | weiss | E | 5 | | | | |
| GND | innerer Schirm | F | 6 | | | | |
| Sinus | gelb | G | 7 | | | | |
| Cosinus | grün | H | 8 | | | | |
| Temp. | schwarz | L | 9 | | | | |
| Schirm | äusserer Schi. | Geh. | 10 | | | | |

Zubehör

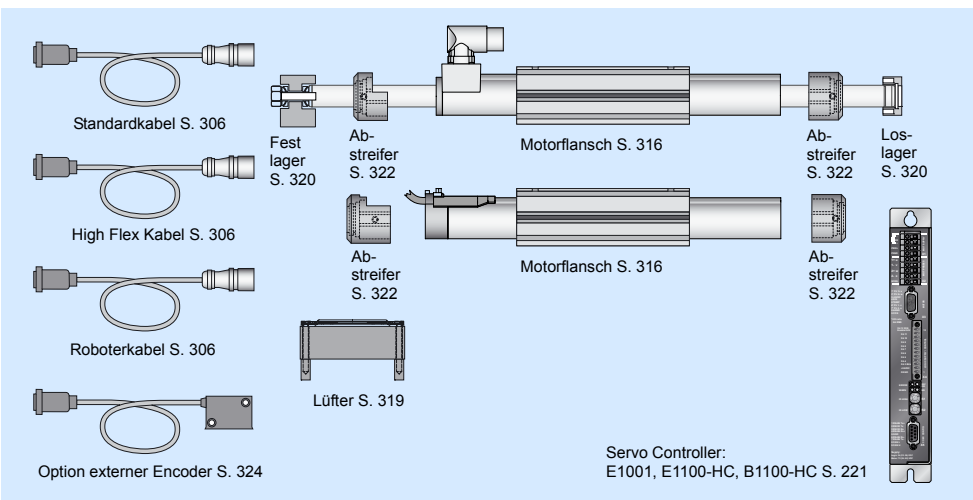

Maximaler Hub: 660mm
Spitzenkraft: 308N

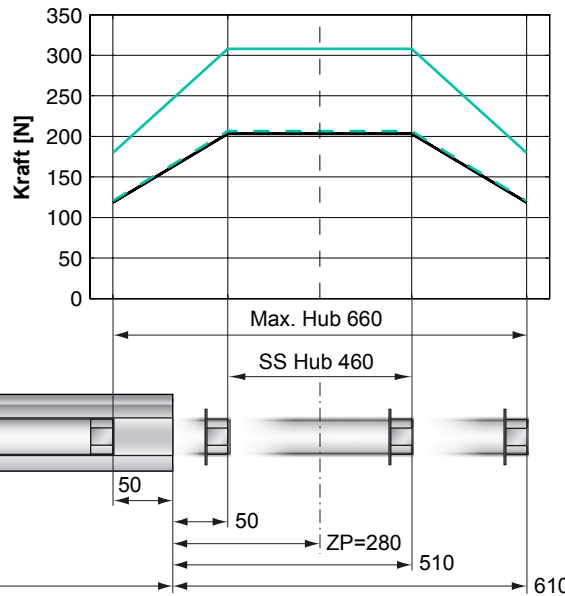

Standard Wicklung:
 — E1100-HC, 72VDC
 — E1100, 72VDC & E1001, 72VDC

F - Wicklung
 — E1100-HC, 72VDC
 - - E1100, 72VDC & E1001, 72VDC

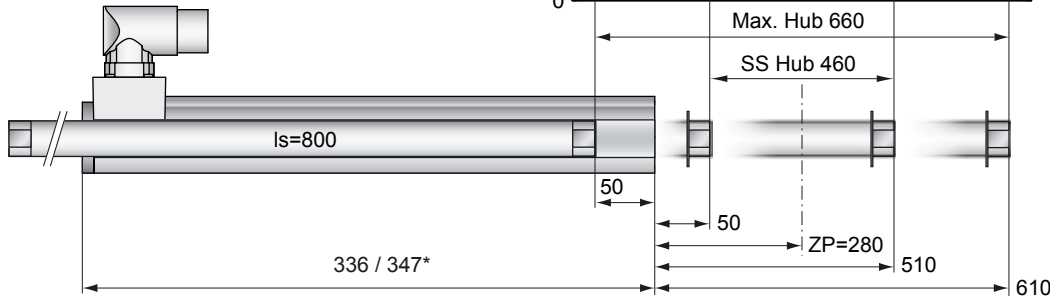

Abmessungen mm
 *Kabel Typ

Motor Spezifikation

| | | Stecker Typ | | Kabel Typ | |
|----------------------------|-------------|-------------------|-------------------|-------------------|---------------------|
| | | Standard Wicklung | F- Wicklung | Standard Wicklung | F- Wicklung |
| P01- | | 37x240/460x660-C | 37x240F/460x660-C | 37x240/460x660 | 37x240F/460x660-C20 |
| Maximaler Hub | mm (in) | 660 (25.98) | 660 (25.98) | 660 (25.98) | 660 (25.98) |
| Kurzhubbereich SS | mm (in) | 460 (18.11) | 460 (18.11) | 460 (18.11) | 460 (18.11) |
| Spitzenkraft E1100-HC | N (lbf) | 203 (45.7) | 308 (69.2) | 203 (45.7) | 308 (69.2) |
| Spitzenkraft E1100 / E1001 | N (lbf) | 203 (45.7) | 206 (46.4) | 203 (45.7) | 206 (46.4) |
| Kont. Kraft | N (lbf) | 53 (12.0) | 53 (12.0) | 53 (12.0) | 53 (12.0) |
| Kont. Kraft mit Lüfter | N (lbf) | 100 (22.4) | 100 (22.4) | 100 (22.4) | 100 (22.4) |
| Randkraft | % | 58 | 58 | 58 | 58 |
| Kraftkonstante | N/A (lbf/A) | 40.8 (9.17) | 25.8 (5.80) | 40.8 (9.17) | 25.8 (5.80) |
| Max. Strom @ 72VDC | A | 5.0 | 11.9 | 5.0 | 11.9 |
| Max. Strom @ 48VDC | A | 3.3 | 8.0 | 3.3 | 8.0 |
| Max. Gesch. @ 72VDC | m/s (in/s) | 1.6 (64) | 2.6 (101) | 1.6 (64) | 2.6 (101) |
| Max. Gesch. @ 48VDC | m/s (in/s) | 1.1 (43) | 1.7 (67) | 1.1 (43) | 1.7 (67) |
| Phasenwider. 25/80 °C | Ohm | 11.7/14.2 | 4.9/5.9 | 11.7/14.2 | 4.9/5.9 |
| Phaseninduktivität | mH | 6.0 | 2.4 | 6.0 | 2.4 |
| Therm. Widerstand | °K/W | 2.3 | 2.2 | 2.3 | 2.2 |
| Therm. Zeitkonstante | sec | 3400 | 3200 | 3400 | 3200 |
| Statordurchmesser | mm (in) | 37 (1.46) | 37 (1.46) | 37 (1.46) | 37 (1.46) |
| Statorlänge | mm (in) | 336 (13.23) | 336 (13.23) | 347 (13.66) | 347 (13.66) |
| Statormasse | g (lb) | 1385 (3.05) | 1385 (3.05) | 1385 (3.05) | 1385 (3.05) |
| Läuferdurchmesser | mm (in) | 20 (0.79) | 20 (0.79) | 20 (0.79) | 20 (0.79) |
| Läuferlänge | mm (in) | 800 (31.50) | 800 (31.50) | 800 (31.50) | 800 (31.50) |
| Läufermasse | g (lb) | 1762 (3.88) | 1762 (3.88) | 1762 (3.88) | 1762 (3.88) |
| Wiederholgenauigkeit | mm (in) | ±0.05 (±0.0020) | ±0.05 (±0.0020) | ±0.05 (±0.0020) | ±0.05 (±0.0020) |
| Linearität | % | ±0.15 | ±0.15 | ±0.15 | ±0.15 |
| Wiederholgenauigk. ES | mm (in) | ±0.01 (±0.0004) | ±0.01 (±0.0004) | ±0.01 (±0.0004) | ±0.01 (±0.0004) |
| Linearität ES | mm (in) | ±0.01 (±0.0004) | ±0.01 (±0.0004) | ±0.01 (±0.0004) | ±0.01 (±0.0004) |

Hub-Zeit Diagramm

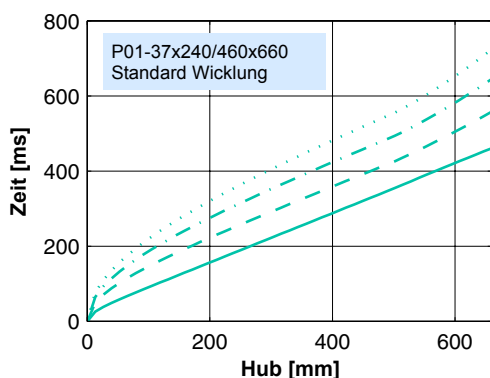

15.0 kg
 10.0 kg
 5.0 kg
 0.0 kg

Bewegter Läufer

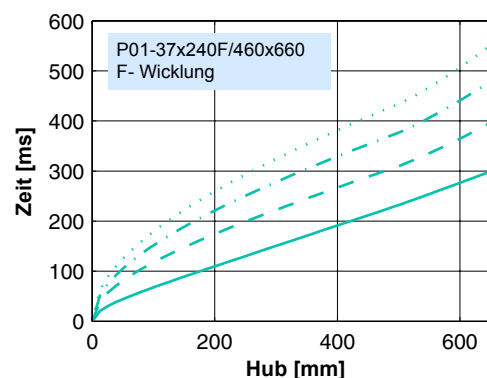

15.0 kg
 10.0 kg
 5.0 kg
 0.0 kg

Bewegter Läufer

Stecker Typ

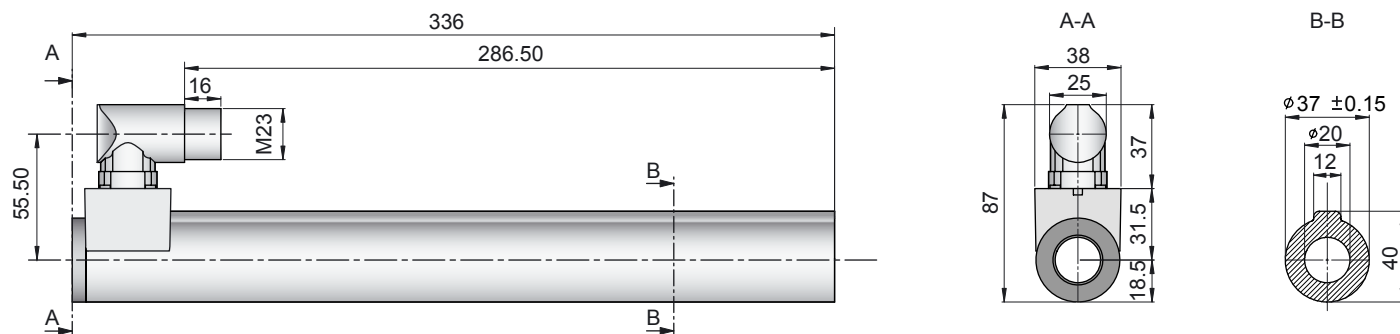

| Linearmotor | | Stator | | Läufer | |
|-----------------------|----------|----------------|-----------|--------|-----------------|
| Typ | Art. Nr. | Typ | Art. Nr. | Typ | Art. Nr. |
| P01-37x240/460x660-C | --> | PS01-37x240-C | 0150-1224 | & | PL01-20x800/720 |
| P01-37x240F/460x660-C | --> | PS01-37x240F-C | 0150-1225 | & | PL01-20x800/720 |
| | | | | | 0150-1334 |

Kabel Typ

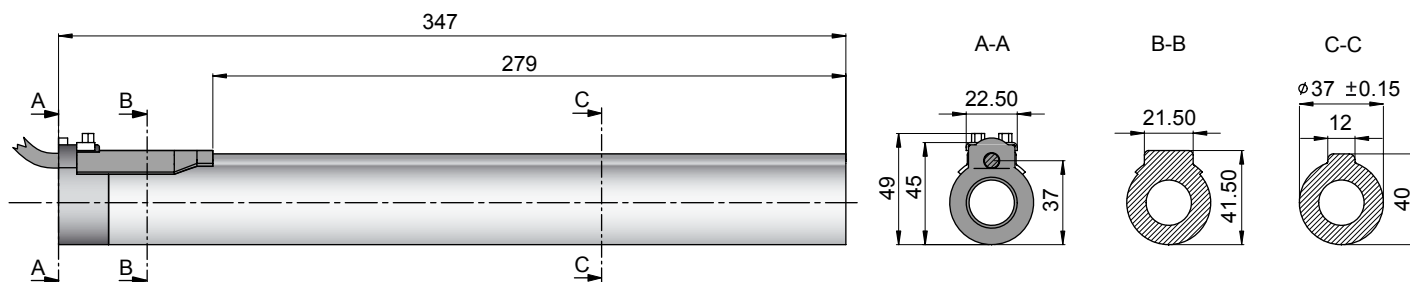

| Linearmotor | | Stator | | Läufer | |
|-------------------------|----------|------------------|-----------|--------|-----------------|
| Typ | Art. Nr. | Typ | Art. Nr. | Typ | Art. Nr. |
| P01-37x240/460x660 | --> | PS01-37x240 | 0150-1203 | & | PL01-20x800/720 |
| P01-37x240/460x660-C20 | --> | PS01-37x240-C20 | 0150-1238 | & | PL01-20x800/720 |
| P01-37x240F/460x660-C20 | --> | PS01-37x240F-C20 | 0150-1239 | & | PL01-20x800/720 |
| | | | | | 0150-1334 |

Läufer

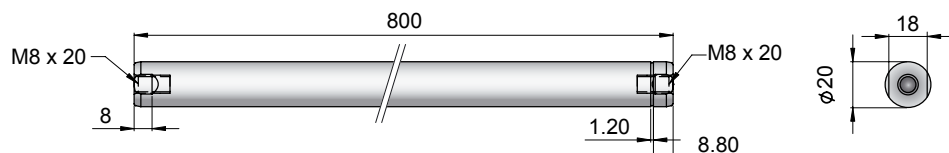

| Standard Läufer | | Standard Läufer | | PL01-20x800/720 | |
|-----------------|--|---|--|-------------------|-----------|
| Spezialläufer | | Heavy Duty Läufer mit WC/C-Beschichtung | | PL02-20x800/720 | |
| | | Lochläufer Innendurchmesser 6.5mm | | PL01-20x800/720-L | |
| | | | | | 0150-1361 |

Stecker

| Motor Steckerbelegung | | P01-37...-C | | P01-37...-C20 | | P01-37... | |
|-----------------------|----------------|-------------|----|---------------|--|-----------|--|
| Kabellänge: | | 1.5m | | 0.2m | | | |
| Ph 1+ | rot | A | 1 | | | | |
| Ph 1- | pink | B | 2 | | | | |
| Ph 2+ | blau | C | 3 | | | | |
| Ph 2- | grau | D | 4 | | | | |
| +5VDC | weiss | E | 5 | | | | |
| GND | innerer Schirm | F | 6 | | | | |
| Sinus | gelb | G | 7 | | | | |
| Cosinus | grün | H | 8 | | | | |
| Temp. | schwarz | L | 9 | | | | |
| Schirm | äusserer Schi. | Geh. | 10 | | | | |

Zubehör

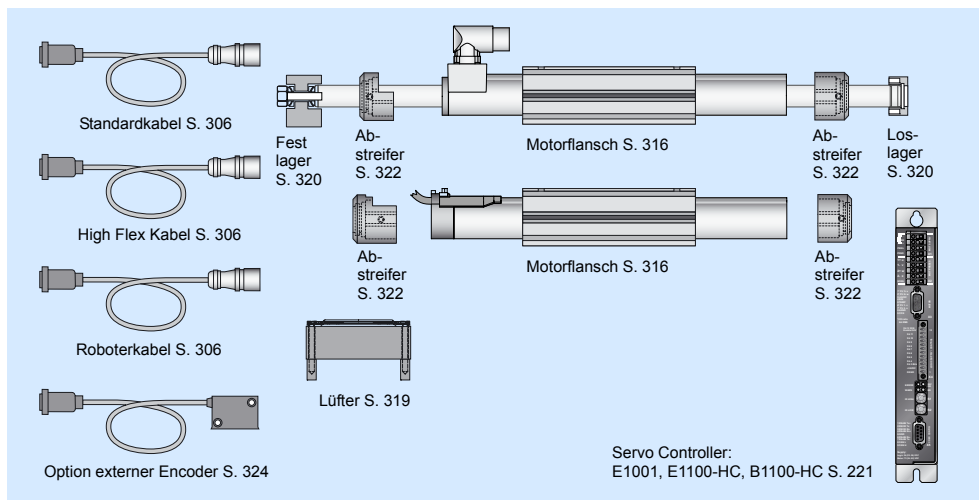

Maximaler Hub: 760mm

Spitzenkraft: 308N

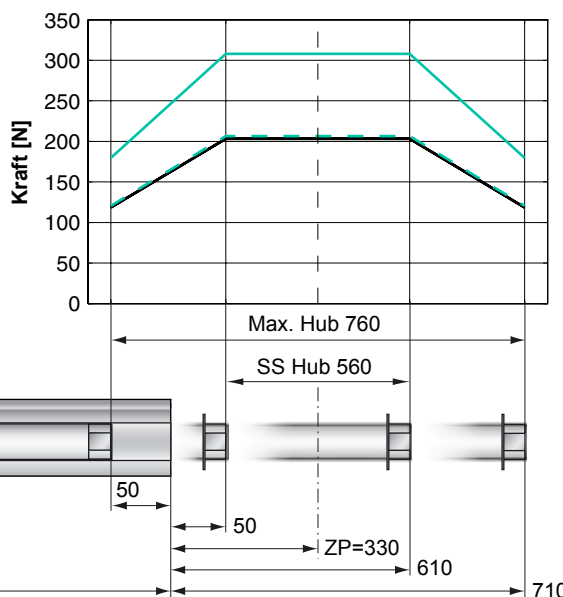

Standard Wicklung:

— E1100-HC, 72VDC
— E1100, 72VDC & E1001, 72VDC

F - Wicklung

— E1100-HC, 72VDC
- - E1100, 72VDC & E1001, 72VDC

Abmessungen mm
*Kabel Typ

Motor Spezifikation

| | | Stecker Typ | | Kabel Typ | |
|----------------------------|-------------|-------------------|-------------------|--------------------------------------|---------------------|
| | | Standard Wicklung | F- Wicklung | Standard Wicklung | F- Wicklung |
| P01- | | 37x240/560x760-C | 37x240F/560x760-C | 37x240/560x760 37x240/560x760-C20 | 37x240F/560x760-C20 |
| Maximaler Hub | mm (in) | 760 (29.92) | 760 (29.92) | 760 (29.92) | 760 (29.92) |
| Kurzhubbereich SS | mm (in) | 560 (22.05) | 560 (22.05) | 560 (22.05) | 560 (22.05) |
| Spitzenkraft E1100-HC | N (lbf) | 203 (45.7) | 308 (69.2) | 203 (45.7) | 308 (69.2) |
| Spitzenkraft E1100 / E1001 | N (lbf) | 203 (45.7) | 206 (46.4) | 203 (45.7) | 206 (46.4) |
| Kont. Kraft | N (lbf) | 53 (12.0) | 53 (12.0) | 53 (12.0) | 53 (12.0) |
| Kont. Kraft mit Lüfter | N (lbf) | 100 (22.4) | 100 (22.4) | 100 (22.4) | 100 (22.4) |
| Randkraft | % | 58 | 58 | 58 | 58 |
| Kraftkonstante | N/A (lbf/A) | 40.8 (9.17) | 25.8 (5.80) | 40.8 (9.17) | 25.8 (5.80) |
| Max. Strom @ 72VDC | A | 5.0 | 11.9 | 5.0 | 11.9 |
| Max. Strom @ 48VDC | A | 3.3 | 8.0 | 3.3 | 8.0 |
| Max. Gesch. @ 72VDC | m/s (in/s) | 1.6 (64) | 2.6 (101) | 1.6 (64) | 2.6 (101) |
| Max. Gesch. @ 48VDC | m/s (in/s) | 1.1 (43) | 1.7 (67) | 1.1 (43) | 1.7 (67) |
| Phasenwider. 25/80 °C | Ohm | 11.7/14.2 | 4.9/5.9 | 11.7/14.2 | 4.9/5.9 |
| Phaseninduktivität | mH | 6.0 | 2.4 | 6.0 | 2.4 |
| Therm. Widerstand | °K/W | 2.3 | 2.2 | 2.3 | 2.2 |
| Therm. Zeitkonstante | sec | 3400 | 3200 | 3400 | 3200 |
| Statordurchmesser | mm (in) | 37 (1.46) | 37 (1.46) | 37 (1.46) | 37 (1.46) |
| Statorlänge | mm (in) | 336 (13.23) | 336 (13.23) | 347 (13.66) | 347 (13.66) |
| Statormasse | g (lb) | 1385 (3.05) | 1385 (3.05) | 1385 (3.05) | 1385 (3.05) |
| Läuferdurchmesser | mm (in) | 20 (0.79) | 20 (0.79) | 20 (0.79) | 20 (0.79) |
| Läuferlänge | mm (in) | 900 (35.43) | 900 (35.43) | 900 (35.43) | 900 (35.43) |
| Läufermasse | g (lb) | 1994 (4.40) | 1994 (4.40) | 1994 (4.40) | 1994 (4.40) |
| Wiederholgenauigkeit | mm (in) | ±0.05 (±0.0020) | ±0.05 (±0.0020) | ±0.05 (±0.0020) | ±0.05 (±0.0020) |
| Linearität | % | ±0.15 | ±0.15 | ±0.15 | ±0.15 |
| Wiederholgenauigk. ES | mm (in) | ±0.01 (±0.0004) | ±0.01 (±0.0004) | ±0.01 (±0.0004) | ±0.01 (±0.0004) |
| Linearität ES | mm (in) | ±0.01 (±0.0004) | ±0.01 (±0.0004) | ±0.01 (±0.0004) | ±0.01 (±0.0004) |

Hub-Zeit Diagramm

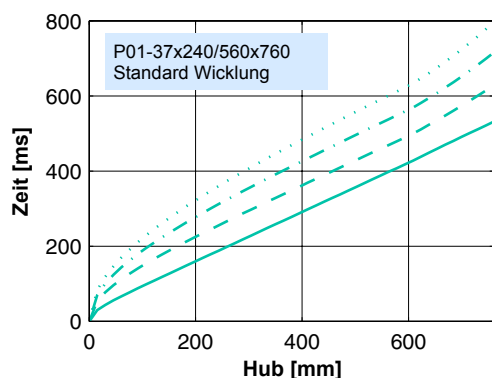

15.0 kg
10.0 kg
5.0 kg
0.0 kg

Bewegter Läufer

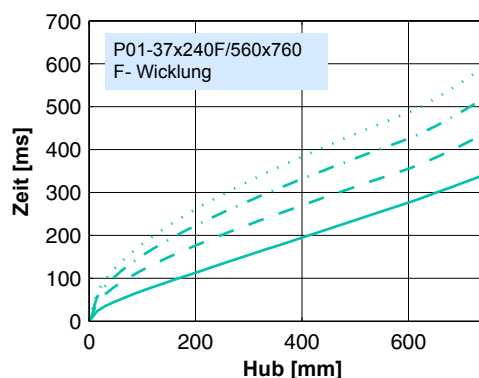

15.0 kg
10.0 kg
5.0 kg
0.0 kg

Bewegter Läufer

Stecker Typ

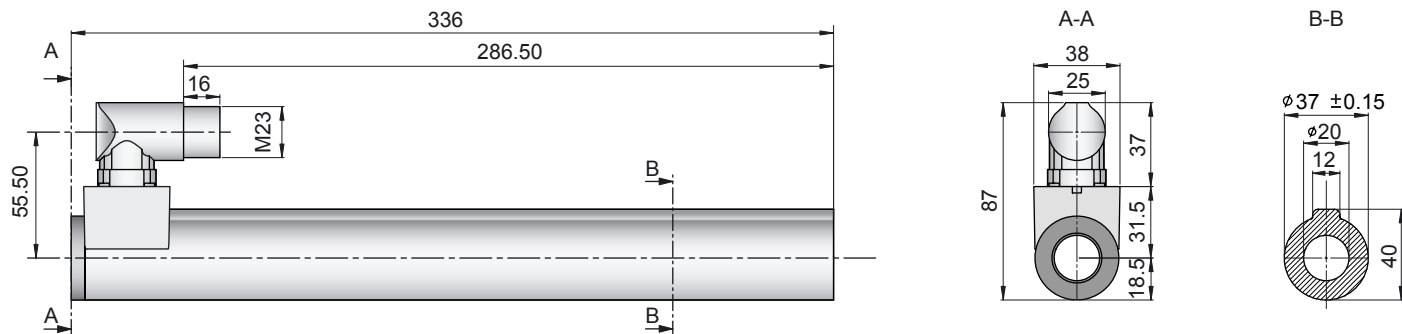

| Linearmotor | | Stator | | | Läufer | |
|-----------------------|----------|----------------|-----------|---|-----------------|-----------|
| Typ | Art. Nr. | Typ | Art. Nr. | | Typ | Art. Nr. |
| P01-37x240/560x760-C | --> | PS01-37x240-C | 0150-1224 | & | PL01-20x900/820 | 0150-1336 |
| P01-37x240F/560x760-C | --> | PS01-37x240F-C | 0150-1225 | & | PL01-20x900/820 | 0150-1336 |

Kabel Typ

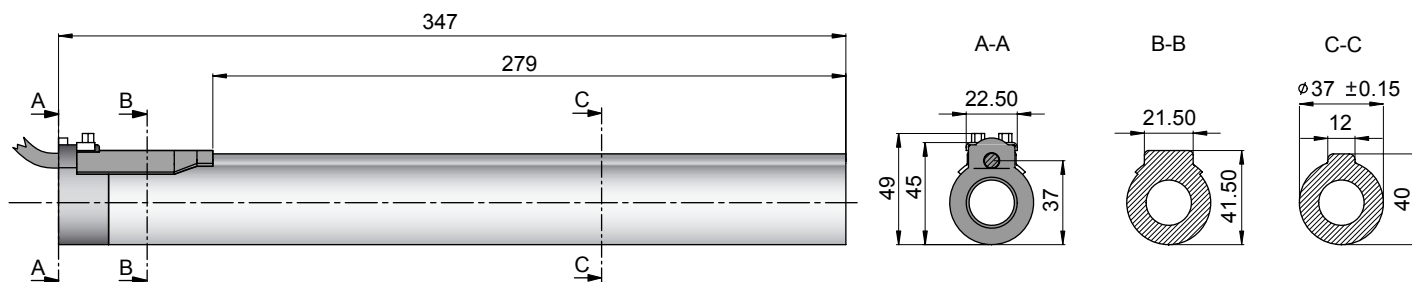

| Linearmotor | | Stator | | | Läufer | |
|-------------------------|----------|------------------|-----------|---|-----------------|-----------|
| Typ | Art. Nr. | Typ | Art. Nr. | | Typ | Art. Nr. |
| P01-37x240/560x760 | --> | PS01-37x240 | 0150-1203 | & | PL01-20x900/820 | 0150-1336 |
| P01-37x240/560x760-C20 | --> | PS01-37x240-C20 | 0150-1238 | & | PL01-20x900/820 | 0150-1336 |
| P01-37x240F/560x760-C20 | --> | PS01-37x240F-C20 | 0150-1239 | & | PL01-20x900/820 | 0150-1336 |

Läufer

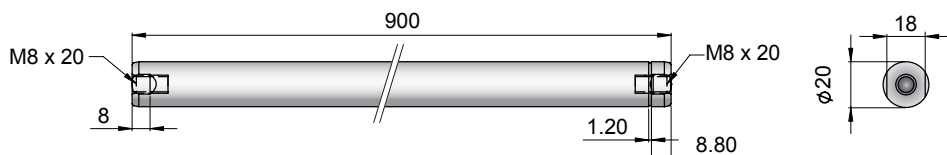

| Standard Läufer | | Standard Läufer | | Läufer | |
|-----------------|--|-------------------|------------------------|-------------------|-----------|
| Spezialläufer | | Heavy Duty Läufer | mit WC/C-Beschichtung | PL01-20x900/820 | 0150-1336 |
| | | | | PL02-20x900/820 | 0150-1337 |
| | | Lochläufer | Innendurchmesser 6.5mm | PL01-20x900/820-L | 0150-1362 |

Stecker

Motor Steckerbelegung

Kabellänge:
P01-37x240... 1.5m
P01-37x240...-C20 0.2m

| Ph 1+ | Ph 1- | Ph 2+ | Ph 2- | +5VDC | GND | Sinus | Cosinus | Temp. | Schirm |
|-------|-------|-------|-------|-------|----------------|-------|---------|---------|----------------|
| rot | pink | blau | grau | weiss | innerer Schirm | gelb | grün | schwarz | äusserer Schi. |
| A | B | C | D | E | F | G | H | L | Geh. |
| 1 | 2 | 3 | 4 | 5 | 6 | 7 | 8 | 9 | 10 |

Zubehör

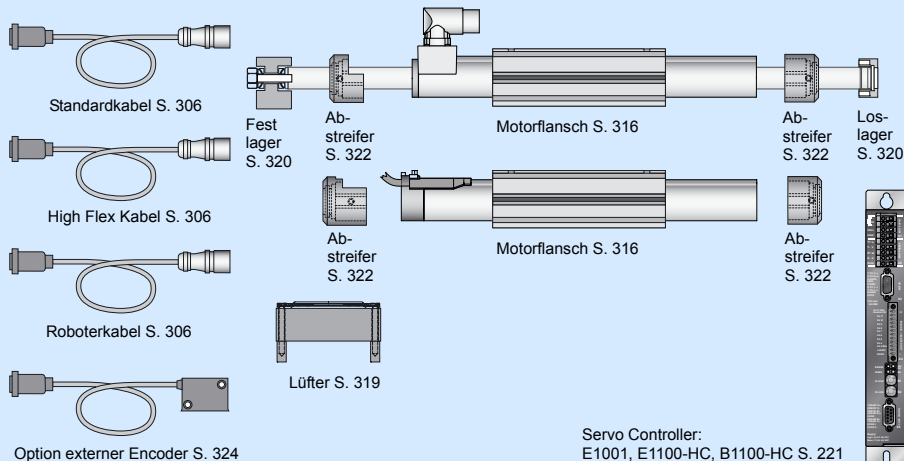

Maximaler Hub: 860mm

Spitzenkraft: 308N

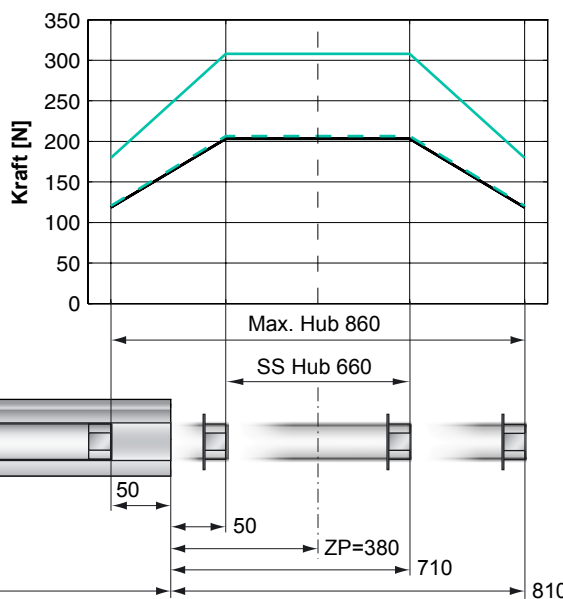

Standard Wicklung:

— E1100-HC, 72VDC
- - E1100, 72VDC & E1001, 72VDC

F - Wicklung

— E1100-HC, 72VDC
- - E1100, 72VDC & E1001, 72VDC

Abmessungen mm
*Kabel Typ

Motor Spezifikation

| | | Stecker Typ | | Kabel Typ | |
|----------------------------|-------------|-------------------|-------------------|-------------------|---------------------|
| | | Standard Wicklung | F- Wicklung | Standard Wicklung | F- Wicklung |
| P01- | | 37x240/660x860-C | 37x240F/660x860-C | 37x240/660x860 | 37x240F/660x860-C20 |
| Maximaler Hub | mm (in) | 860 (33.86) | 860 (33.86) | 860 (33.86) | 860 (33.86) |
| Kurzhubbereich SS | mm (in) | 660 (25.98) | 660 (25.98) | 660 (25.98) | 660 (25.98) |
| Spitzenkraft E1100-HC | N (lbf) | 203 (45.7) | 308 (69.2) | 203 (45.7) | 308 (69.2) |
| Spitzenkraft E1100 / E1001 | N (lbf) | 203 (45.7) | 206 (46.4) | 203 (45.7) | 206 (46.4) |
| Kont. Kraft | N (lbf) | 53 (12.0) | 53 (12.0) | 53 (12.0) | 53 (12.0) |
| Kont. Kraft mit Lüfter | N (lbf) | 100 (22.4) | 100 (22.4) | 100 (22.4) | 100 (22.4) |
| Randkraft | % | 58 | 58 | 58 | 58 |
| Kraftkonstante | N/A (lbf/A) | 40.8 (9.17) | 25.8 (5.80) | 40.8 (9.17) | 25.8 (5.80) |
| Max. Strom @ 72VDC | A | 5.0 | 11.9 | 5.0 | 11.9 |
| Max. Strom @ 48VDC | A | 3.3 | 8.0 | 3.3 | 8.0 |
| Max. Gesch. @ 72VDC | m/s (in/s) | 1.6 (64) | 2.6 (101) | 1.6 (64) | 2.6 (101) |
| Max. Gesch. @ 48VDC | m/s (in/s) | 1.1 (43) | 1.7 (67) | 1.1 (43) | 1.7 (67) |
| Phasenwider. 25/80 °C | Ohm | 11.7/14.2 | 4.9/5.9 | 11.7/14.2 | 4.9/5.9 |
| Phaseninduktivität | mH | 6.0 | 2.4 | 6.0 | 2.4 |
| Therm. Widerstand | °K/W | 2.3 | 2.2 | 2.3 | 2.2 |
| Therm. Zeitkonstante | sec | 3400 | 3200 | 3400 | 3200 |
| Statordurchmesser | mm (in) | 37 (1.46) | 37 (1.46) | 37 (1.46) | 37 (1.46) |
| Statorlänge | mm (in) | 336 (13.23) | 336 (13.23) | 347 (13.66) | 347 (13.66) |
| Statormasse | g (lb) | 1385 (3.05) | 1385 (3.05) | 1385 (3.05) | 1385 (3.05) |
| Läuferdurchmesser | mm (in) | 20 (0.79) | 20 (0.79) | 20 (0.79) | 20 (0.79) |
| Läuferlänge | mm (in) | 1000 (39.37) | 1000 (39.37) | 1000 (39.37) | 1000 (39.37) |
| Läufermasse | g (lb) | 2227 (4.91) | 2227 (4.91) | 2227 (4.91) | 2227 (4.91) |
| Wiederholgenauigkeit | mm (in) | ±0.05 (±0.0020) | ±0.05 (±0.0020) | ±0.05 (±0.0020) | ±0.05 (±0.0020) |
| Linearität | % | ±0.15 | ±0.15 | ±0.15 | ±0.15 |
| Wiederholgenauigk. ES | mm (in) | ±0.01 (±0.0004) | ±0.01 (±0.0004) | ±0.01 (±0.0004) | ±0.01 (±0.0004) |
| Linearität ES | mm (in) | ±0.01 (±0.0004) | ±0.01 (±0.0004) | ±0.01 (±0.0004) | ±0.01 (±0.0004) |

Hub-Zeit Diagramm

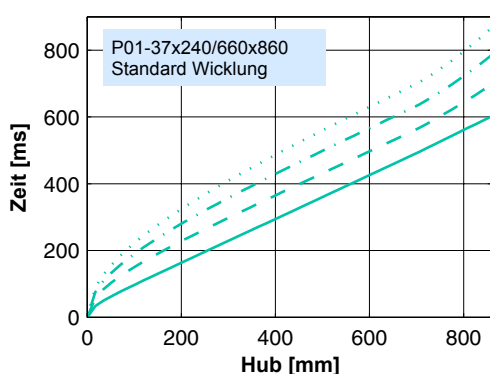

15.0 kg
10.0 kg
5.0 kg
0.0 kg

Bewegter Läufer

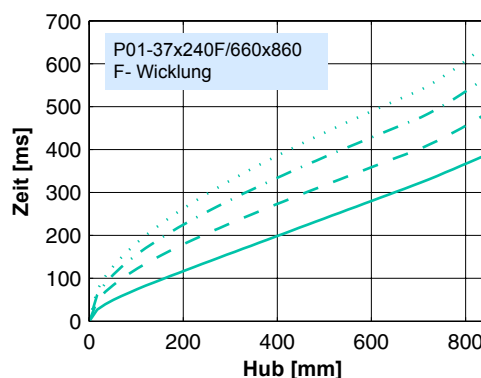

15.0 kg
10.0 kg
5.0 kg
0.0 kg

Bewegter Läufer

Stecker Typ

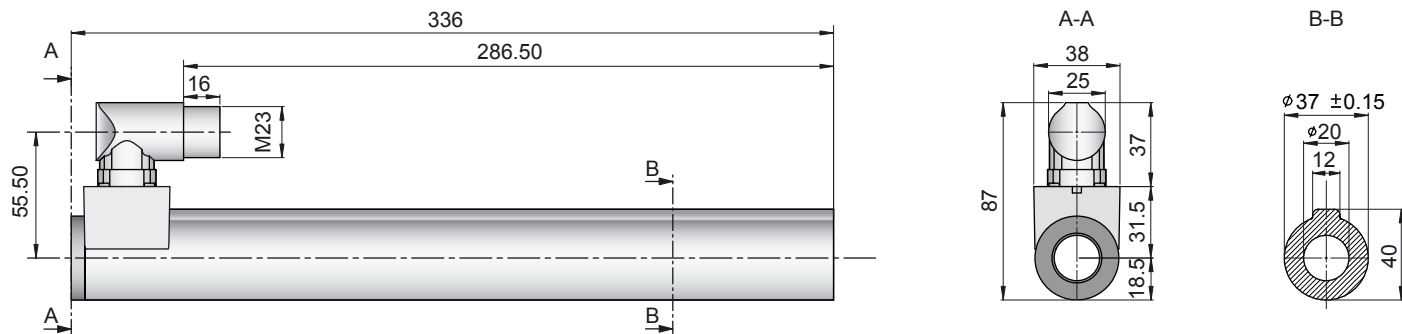

| Linearmotor | | Stator | | | Läufer | |
|-----------------------|----------|----------------|-----------|---|------------------|-----------|
| Typ | Art. Nr. | Typ | Art. Nr. | | Typ | Art. Nr. |
| P01-37x240/660x860-C | --> | PS01-37x240-C | 0150-1224 | & | PL01-20x1000/920 | 0150-1338 |
| P01-37x240F/660x860-C | --> | PS01-37x240F-C | 0150-1225 | & | PL01-20x1000/920 | 0150-1338 |

Kabel Typ

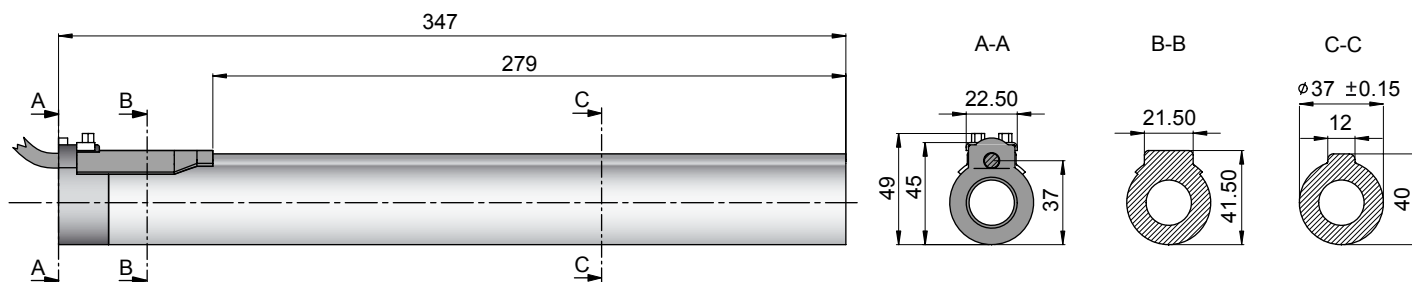

| Linearmotor | | Stator | | | Läufer | |
|-------------------------|----------|------------------|-----------|---|------------------|-----------|
| Typ | Art. Nr. | Typ | Art. Nr. | | Typ | Art. Nr. |
| P01-37x240/660x860 | --> | PS01-37x240 | 0150-1203 | & | PL01-20x1000/920 | 0150-1338 |
| P01-37x240/660x860-C20 | --> | PS01-37x240-C20 | 0150-1238 | & | PL01-20x1000/920 | 0150-1338 |
| P01-37x240F/660x860-C20 | --> | PS01-37x240F-C20 | 0150-1239 | & | PL01-20x1000/920 | 0150-1338 |

Läufer

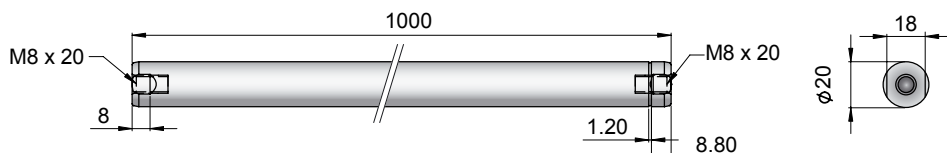

| Standard Läufer | | Standard Läufer | | Läufer | |
|-----------------|--|-------------------|------------------------|--------------------|-------------|
| Spezialläufer | | Heavy Duty Läufer | mit WC/C-Beschichtung | PL01-20x1000/920 | 0150-1338 |
| | | | | PL02-20x1000/920 | auf Anfrage |
| | | Lochläufer | Innendurchmesser 6.5mm | PL01-20x1000/920-L | 0150-1364 |

Stecker

| Motor Steckerbelegung | | P01-37...-C | | P01-37...-C20 | | P01-37... | |
|-----------------------|----------------|-------------|----|---------------|--|-----------|--|
| Kabellänge: | | | | | | | |
| P01-37x240... | 1.5m | | | | | | |
| P01-37x240...-C20 | 0.2m | | | | | | |
| Ph 1+ | rot | A | 1 | | | | |
| Ph 1- | pink | B | 2 | | | | |
| Ph 2+ | blau | C | 3 | | | | |
| Ph 2- | grau | D | 4 | | | | |
| +5VDC | weiss | E | 5 | | | | |
| GND | innerer Schirm | F | 6 | | | | |
| Sinus | gelb | G | 7 | | | | |
| Cosinus | grün | H | 8 | | | | |
| Temp. | schwarz | L | 9 | | | | |
| Schirm | äusserer Schi. | Geh. | 10 | | | | |

Zubehör

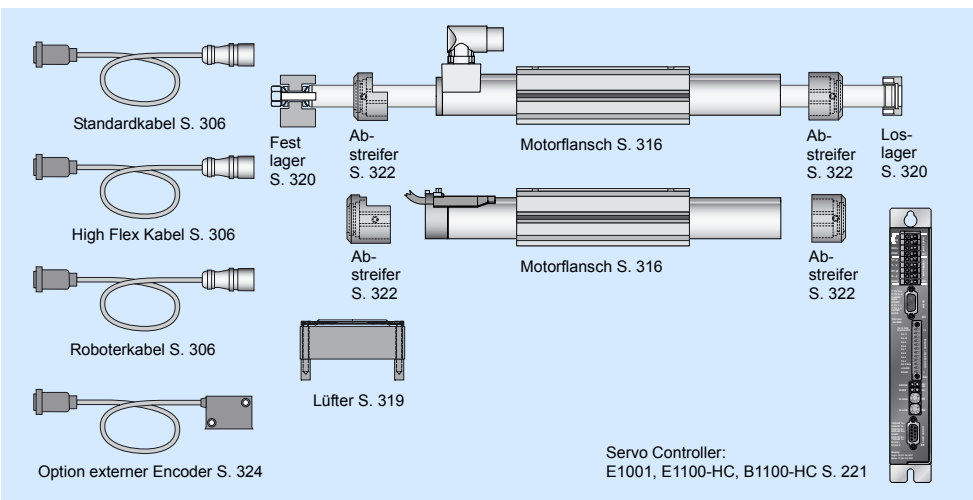

Maximaler Hub: 1060mm
Spitzenkraft: 308N

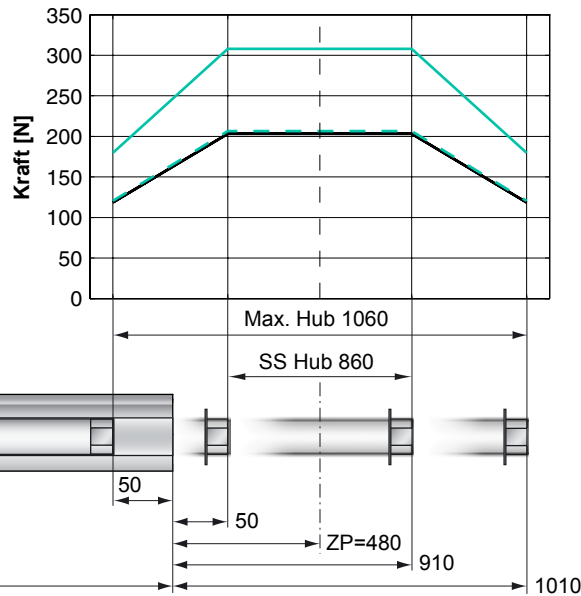

Standard Wicklung:

— E1100-HC, 72VDC
 — E1100, 72VDC & E1001, 72VDC

F - Wicklung

— E1100-HC, 72VDC
 - - E1100, 72VDC & E1001, 72VDC

Abmessungen mm
 *Kabel Typ

Motor Spezifikation

| | | Stecker Typ | | Kabel Typ | |
|----------------------------|-------------|-------------------|--------------------|-------------------|----------------------|
| | | Standard Wicklung | F- Wicklung | Standard Wicklung | F- Wicklung |
| P01- | | 37x240/860x1060-C | 37x240F/860x1060-C | 37x240/860x1060 | 37x240F/860x1060-C20 |
| Maximaler Hub | mm (in) | 1060 (41.73) | 1060 (41.73) | 1060 (41.73) | 1060 (41.73) |
| Kurzhubbereich SS | mm (in) | 860 (33.86) | 860 (33.86) | 860 (33.86) | 860 (33.86) |
| Spitzenkraft E1100-HC | N (lbf) | 203 (45.7) | 308 (69.2) | 203 (45.7) | 308 (69.2) |
| Spitzenkraft E1100 / E1001 | N (lbf) | 203 (45.7) | 206 (46.4) | 203 (45.7) | 206 (46.4) |
| Kont. Kraft | N (lbf) | 53 (12.0) | 53 (12.0) | 53 (12.0) | 53 (12.0) |
| Kont. Kraft mit Lüfter | N (lbf) | 100 (22.4) | 100 (22.4) | 100 (22.4) | 100 (22.4) |
| Randkraft | % | 58 | 58 | 58 | 58 |
| Kraftkonstante | N/A (lbf/A) | 40.8 (9.17) | 25.8 (5.80) | 40.8 (9.17) | 25.8 (5.80) |
| Max. Strom @ 72VDC | A | 5.0 | 11.9 | 5.0 | 11.9 |
| Max. Strom @ 48VDC | A | 3.3 | 8.0 | 3.3 | 8.0 |
| Max. Gesch. @ 72VDC | m/s (in/s) | 1.6 (64) | 2.6 (101) | 1.6 (64) | 2.6 (101) |
| Max. Gesch. @ 48VDC | m/s (in/s) | 1.1 (43) | 1.7 (67) | 1.1 (43) | 1.7 (67) |
| Phasenwider. 25/80 °C | Ohm | 11.7/14.2 | 4.9/5.9 | 11.7/14.2 | 4.9/5.9 |
| Phaseninduktivität | mH | 6.0 | 2.4 | 6.0 | 2.4 |
| Therm. Widerstand | °K/W | 2.3 | 2.2 | 2.3 | 2.2 |
| Therm. Zeitkonstante | sec | 3400 | 3200 | 3400 | 3200 |
| Statordurchmesser | mm (in) | 37 (1.46) | 37 (1.46) | 37 (1.46) | 37 (1.46) |
| Statorlänge | mm (in) | 336 (13.23) | 336 (13.23) | 347 (13.66) | 347 (13.66) |
| Statormasse | g (lb) | 1385 (3.05) | 1385 (3.05) | 1385 (3.05) | 1385 (3.05) |
| Läuferdurchmesser | mm (in) | 20 (0.79) | 20 (0.79) | 20 (0.79) | 20 (0.79) |
| Läuferlänge | mm (in) | 1200 (47.24) | 1200 (47.24) | 1200 (47.24) | 1200 (47.24) |
| Läufermasse | g (lb) | 2692 (5.93) | 2692 (5.93) | 2692 (5.93) | 2692 (5.93) |
| Wiederholgenauigkeit | mm (in) | ±0.05 (±0.0020) | ±0.05 (±0.0020) | ±0.05 (±0.0020) | ±0.05 (±0.0020) |
| Linearität | % | ±0.10 | ±0.10 | ±0.10 | ±0.10 |
| Wiederholgenauigk. ES | mm (in) | ±0.01 (±0.0004) | ±0.01 (±0.0004) | ±0.01 (±0.0004) | ±0.01 (±0.0004) |
| Linearität ES | mm (in) | ±0.01 (±0.0004) | ±0.01 (±0.0004) | ±0.01 (±0.0004) | ±0.01 (±0.0004) |

Hub-Zeit Diagramm

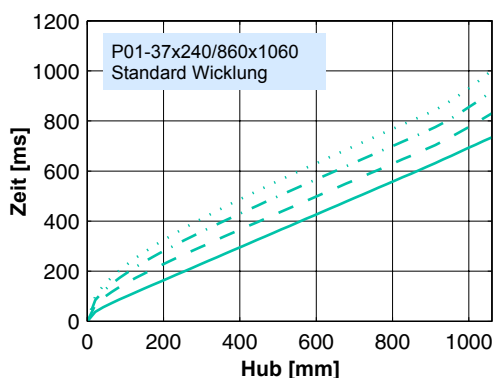

15.0 kg
 10.0 kg
 5.0 kg
 0.0 kg

Bewegter Stator

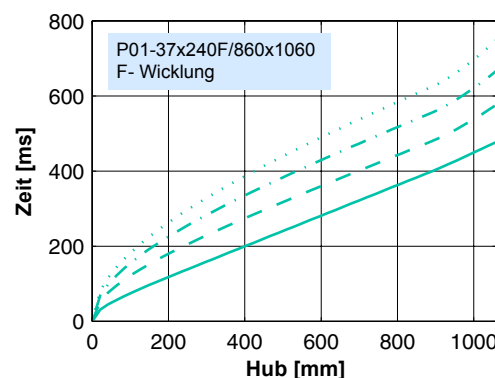

15.0 kg
 10.0 kg
 5.0 kg
 0.0 kg

Bewegter Stator

Stecker Typ

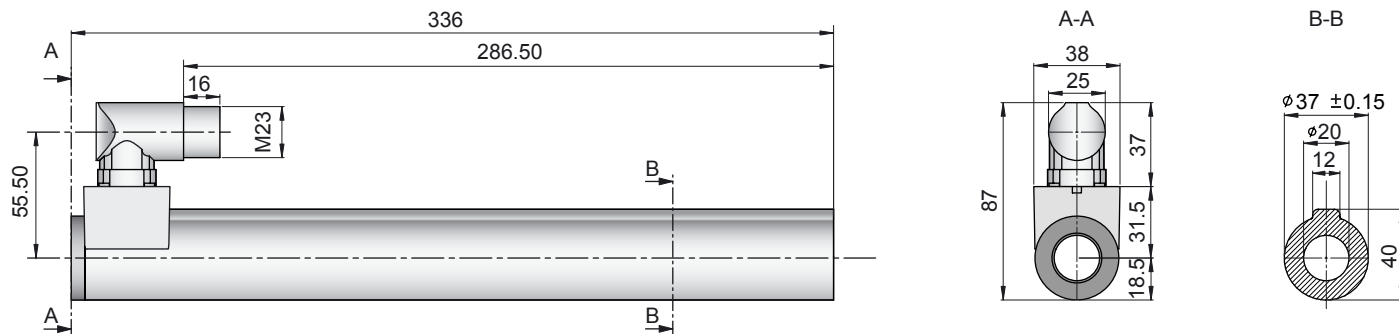

| Linearmotor | | Stator | | Läufer | |
|------------------------|----------|----------------|-----------|--------|-------------------|
| Typ | Art. Nr. | Typ | Art. Nr. | Typ | Art. Nr. |
| P01-37x240/860x1060-C | --> | PS01-37x240-C | 0150-1224 | & | PL01-20x1200/1120 |
| P01-37x240F/860x1060-C | --> | PS01-37x240F-C | 0150-1225 | & | PL01-20x1200/1120 |
| | | | | | 0150-1340 |

Kabel Typ

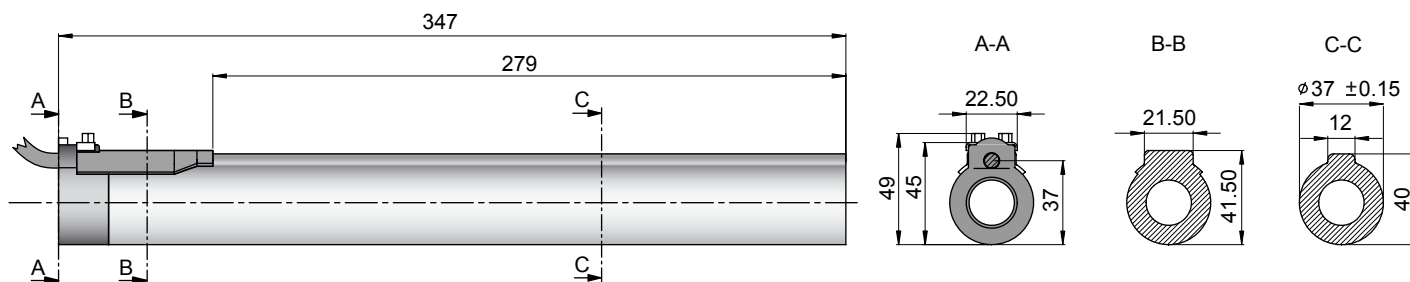

| Linearmotor | | Stator | | Läufer | |
|--------------------------|----------|------------------|-----------|--------|-------------------|
| Typ | Art. Nr. | Typ | Art. Nr. | Typ | Art. Nr. |
| P01-37x240/860x1060 | --> | PS01-37x240 | 0150-1203 | & | PL01-20x1200/1120 |
| P01-37x240/860x1060-C20 | --> | PS01-37x240-C20 | 0150-1238 | & | PL01-20x1200/1120 |
| P01-37x240F/860x1060-C20 | --> | PS01-37x240F-C20 | 0150-1239 | & | PL01-20x1200/1120 |
| | | | | | 0150-1340 |

Läufer

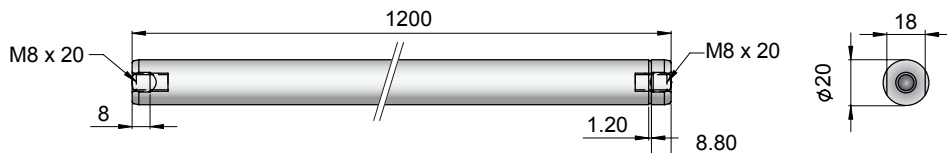

| Standard Läufer | | Standard Läufer | | PL01-20x1200/1120 | |
|-----------------|--|---|------------------------|---------------------|-------------|
| Spezialläufer | | Heavy Duty Läufer mit WC/C-Beschichtung | | 0150-1340 | |
| | | | | | auf Anfrage |
| | | Lochläufer | Innendurchmesser 6.5mm | PL01-20x1200/1120-L | 0150-1376 |

Stecker

| Motor Steckerbelegung | | P01-37...-C | | P01-37...-C20 | | P01-37... | |
|-----------------------|----------------|-------------|----|---------------|--|-----------|--|
| Kabellänge: | | 1.5m | | 0.2m | | | |
| Ph 1+ | rot | A | 1 | | | | |
| Ph 1- | pink | B | 2 | | | | |
| Ph 2+ | blau | C | 3 | | | | |
| Ph 2- | grau | D | 4 | | | | |
| +5VDC | weiss | E | 5 | | | | |
| GND | innerer Schirm | F | 6 | | | | |
| Sinus | gelb | G | 7 | | | | |
| Cosinus | grün | H | 8 | | | | |
| Temp. | schwarz | L | 9 | | | | |
| Schirm | äusserer Schi. | Geh. | 10 | | | | |

Zubehör

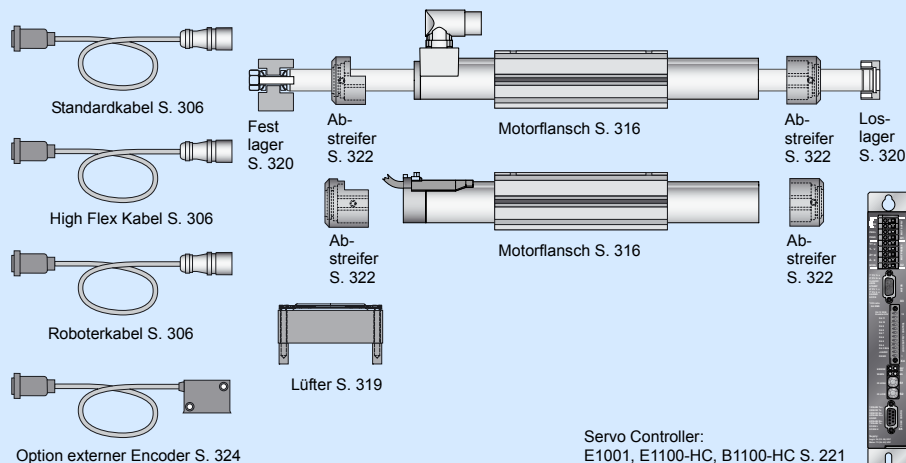

Maximaler Hub: 1260mm

Spitzenkraft: 308N

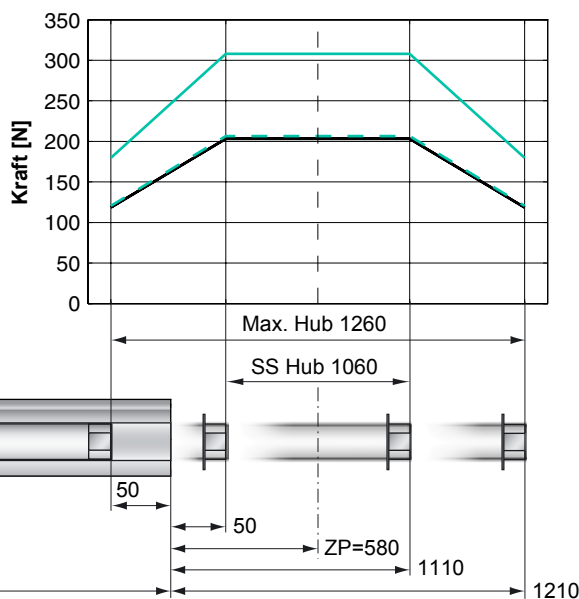

Standard Wicklung:

— E1100-HC, 72VDC
— E1100, 72VDC & E1001, 72VDC

F - Wicklung

— E1100-HC, 72VDC
- - E1100, 72VDC & E1001, 72VDC

Abmessungen mm
*Kabel Typ

Motor Spezifikation

| | | Stecker Typ | | Kabel Typ | |
|----------------------------|-------------|--------------------|---------------------|--|-----------------------|
| | | Standard Wicklung | F- Wicklung | Standard Wicklung | F- Wicklung |
| P01- | | 37x240/1060x1260-C | 37x240F/1060x1260-C | 37x240/1060x1260 37x240/1060x1260-C20 | 37x240F/1060x1260-C20 |
| Maximaler Hub | mm (in) | 1260 (49.61) | 1260 (49.61) | 1260 (49.61) | 1260 (49.61) |
| Kurzhubbereich SS | mm (in) | 1060 (41.73) | 1060 (41.73) | 1060 (41.73) | 1060 (41.73) |
| Spitzenkraft E1100-HC | N (lbf) | 203 (45.7) | 308 (69.2) | 203 (45.7) | 308 (69.2) |
| Spitzenkraft E1100 / E1001 | N (lbf) | 203 (45.7) | 206 (46.4) | 203 (45.7) | 206 (46.4) |
| Kont. Kraft | N (lbf) | 53 (12.0) | 53 (12.0) | 53 (12.0) | 53 (12.0) |
| Kont. Kraft mit Lüfter | N (lbf) | 100 (22.4) | 100 (22.4) | 100 (22.4) | 100 (22.4) |
| Randkraft | % | 58 | 58 | 58 | 58 |
| Kraftkonstante | N/A (lbf/A) | 40.8 (9.17) | 25.8 (5.80) | 40.8 (9.17) | 25.8 (5.80) |
| Max. Strom @ 72VDC | A | 5.0 | 11.9 | 5.0 | 11.9 |
| Max. Strom @ 48VDC | A | 3.3 | 8.0 | 3.3 | 8.0 |
| Max. Gesch. @ 72VDC | m/s (in/s) | 1.6 (64) | 2.6 (101) | 1.6 (64) | 2.6 (101) |
| Max. Gesch. @ 48VDC | m/s (in/s) | 1.1 (43) | 1.7 (67) | 1.1 (43) | 1.7 (67) |
| Phasenwider. 25/80 °C | Ohm | 11.7/14.2 | 4.9/5.9 | 11.7/14.2 | 4.9/5.9 |
| Phaseninduktivität | mH | 6.0 | 2.4 | 6.0 | 2.4 |
| Therm. Widerstand | °K/W | 2.3 | 2.2 | 2.3 | 2.2 |
| Therm. Zeitkonstante | sec | 3400 | 3200 | 3400 | 3200 |
| Statordurchmesser | mm (in) | 37 (1.46) | 37 (1.46) | 37 (1.46) | 37 (1.46) |
| Statorlänge | mm (in) | 336 (13.23) | 336 (13.23) | 347 (13.66) | 347 (13.66) |
| Statormasse | g (lb) | 1385 (3.05) | 1385 (3.05) | 1385 (3.05) | 1385 (3.05) |
| Läuferdurchmesser | mm (in) | 20 (0.79) | 20 (0.79) | 20 (0.79) | 20 (0.79) |
| Läuferlänge | mm (in) | 1400 (55.12) | 1400 (55.12) | 1400 (55.12) | 1400 (55.12) |
| Läufermasse | g (lb) | 3157 (6.96) | 3157 (6.96) | 3157 (6.96) | 3157 (6.96) |
| Wiederholgenauigkeit | mm (in) | ±0.05 (±0.0020) | ±0.05 (±0.0020) | ±0.05 (±0.0020) | ±0.05 (±0.0020) |
| Linearität | % | ±0.10 | ±0.10 | ±0.10 | ±0.10 |
| Wiederholgenauigk. ES | mm (in) | ±0.01 (±0.0004) | ±0.01 (±0.0004) | ±0.01 (±0.0004) | ±0.01 (±0.0004) |
| Linearität ES | mm (in) | ±0.01 (±0.0004) | ±0.01 (±0.0004) | ±0.01 (±0.0004) | ±0.01 (±0.0004) |

Hub-Zeit Diagramm

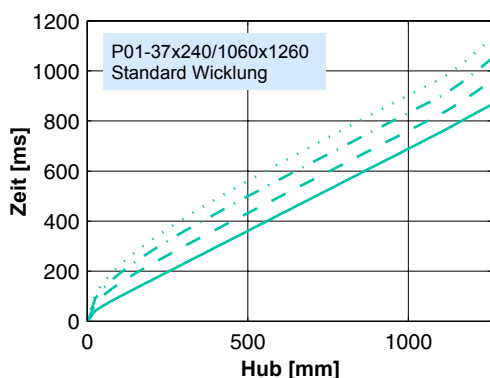

15.0 kg
10.0 kg
5.0 kg
0.0 kg

Bewegter Stator

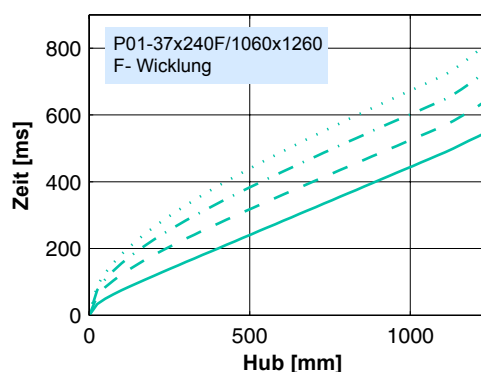

15.0 kg
10.0 kg
5.0 kg
0.0 kg

Bewegter Stator

Stecker Typ

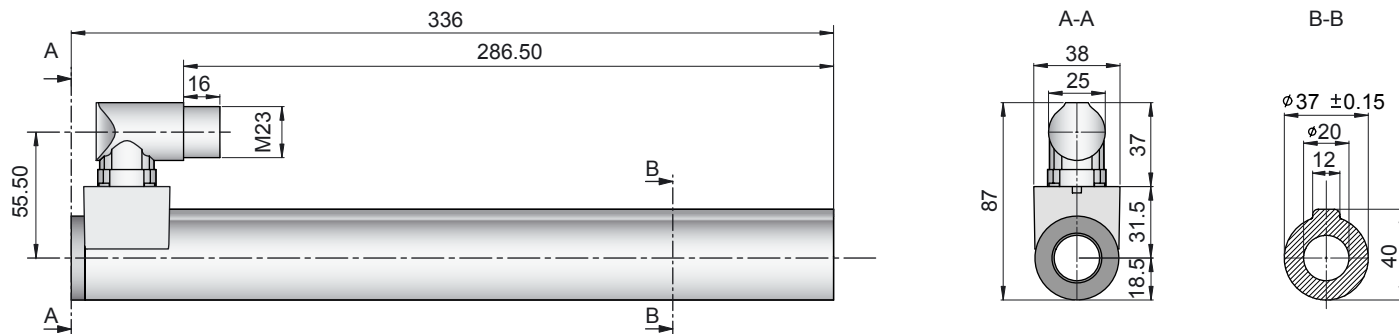

| Linearmotor | | Stator | | Läufer | |
|-------------------------|----------|----------------|-----------|--------|-------------------|
| Typ | Art. Nr. | Typ | Art. Nr. | Typ | Art. Nr. |
| P01-37x240/1060x1260-C | --> | PS01-37x240-C | 0150-1224 | & | PL01-20x1400/1320 |
| P01-37x240F/1060x1260-C | --> | PS01-37x240F-C | 0150-1225 | & | PL01-20x1400/1320 |
| | | | | | 0150-1342 |

Kabel Typ

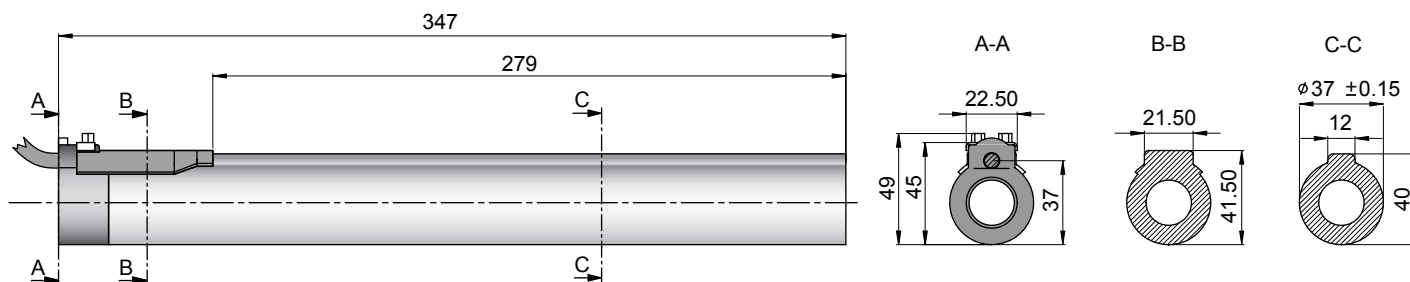

| Linearmotor | | Stator | | Läufer | |
|---------------------------|----------|------------------|-----------|--------|-------------------|
| Typ | Art. Nr. | Typ | Art. Nr. | Typ | Art. Nr. |
| P01-37x240/1060x1260 | --> | PS01-37x240 | 0150-1203 | & | PL01-20x1400/1320 |
| P01-37x240/1060x1260-C20 | --> | PS01-37x240-C20 | 0150-1238 | & | PL01-20x1400/1320 |
| P01-37x240F/1060x1260-C20 | --> | PS01-37x240F-C20 | 0150-1239 | & | PL01-20x1400/1320 |
| | | | | | 0150-1342 |

Läufer

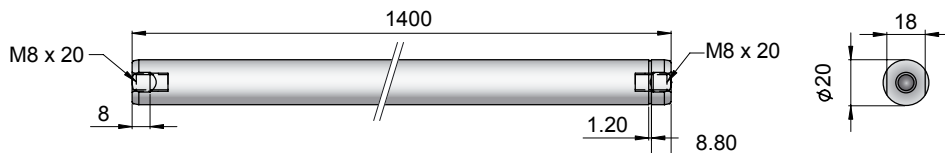

| Standard Läufer | | Standard Läufer | | PL01-20x1400/1320 | |
|-----------------|--|---|--|---------------------|-------------|
| Spezialläufer | | Heavy Duty Läufer mit WC/C-Beschichtung | | PL02-20x1400/1320 | |
| | | Lochläufer Innendurchmesser 6.5mm | | PL01-20x1400/1320-L | |
| | | | | | auf Anfrage |

Stecker

| Motor Steckerbelegung | | P01-37...-C | | P01-37...-C20 | | P01-37... | |
|-----------------------|----------------|-------------|----|---------------|--|-----------|--|
| Kabellänge: | | 1.5m | | 0.2m | | | |
| Ph 1+ | rot | A | 1 | | | | |
| Ph 1- | pink | B | 2 | | | | |
| Ph 2+ | blau | C | 3 | | | | |
| Ph 2- | grau | D | 4 | | | | |
| +5VDC | weiss | E | 5 | | | | |
| GND | innerer Schirm | F | 6 | | | | |
| Sinus | gelb | G | 7 | | | | |
| Cosinus | grün | H | 8 | | | | |
| Temp. | schwarz | L | 9 | | | | |
| Schirm | äusserer Schi. | Geh. | 10 | | | | |

Zubehör

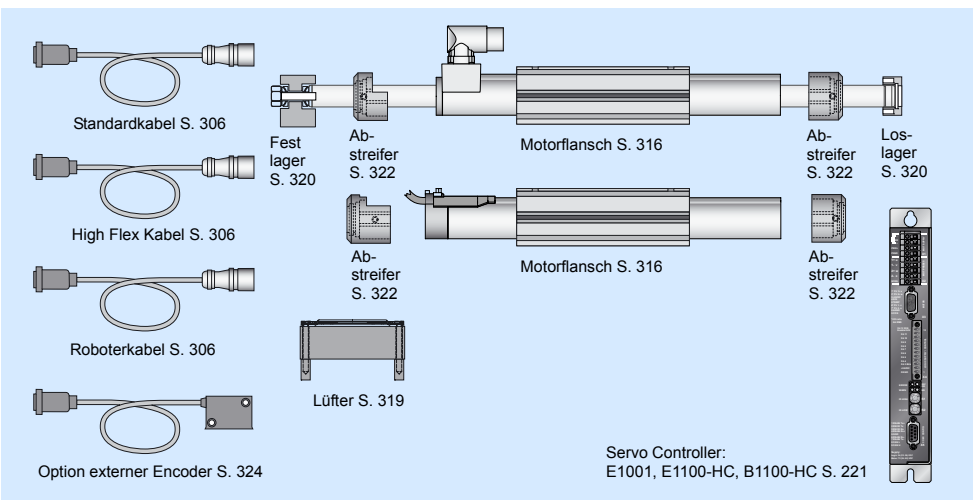

Maximaler Hub: 1460mm

Spitzenkraft: 308N

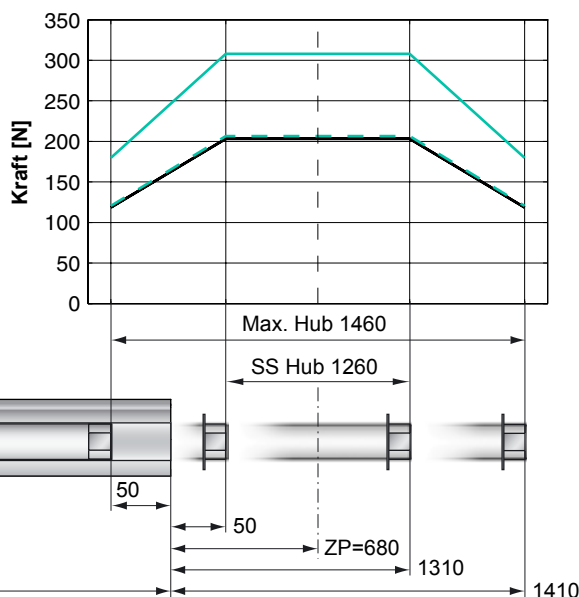

Standard Wicklung:

— E1100-HC, 72VDC
- - E1100, 72VDC & E1001, 72VDC

F - Wicklung

— E1100-HC, 72VDC
- - E1100, 72VDC & E1001, 72VDC

Abmessungen mm
*Kabel Typ

Motor Spezifikation

| | | Stecker Typ | | Kabel Typ | |
|----------------------------|-------------|--------------------|---------------------|--|-----------------------|
| | | Standard Wicklung | F- Wicklung | Standard Wicklung | F- Wicklung |
| P01- | | 37x240/1260x1460-C | 37x240F/1260x1460-C | 37x240/1260x1460 37x240/1260x1460-C20 | 37x240F/1260x1460-C20 |
| Maximaler Hub | mm (in) | 1460 (57.48) | 1460 (57.48) | 1460 (57.48) | 1460 (57.48) |
| Kurzhubbereich SS | mm (in) | 1260 (49.61) | 1260 (49.61) | 1260 (49.61) | 1260 (49.61) |
| Spitzenkraft E1100-HC | N (lbf) | 203 (45.7) | 308 (69.2) | 203 (45.7) | 308 (69.2) |
| Spitzenkraft E1100 / E1001 | N (lbf) | 203 (45.7) | 206 (46.4) | 203 (45.7) | 206 (46.4) |
| Kont. Kraft | N (lbf) | 53 (12.0) | 53 (12.0) | 53 (12.0) | 53 (12.0) |
| Kont. Kraft mit Lüfter | N (lbf) | 100 (22.4) | 100 (22.4) | 100 (22.4) | 100 (22.4) |
| Randkraft | % | 58 | 58 | 58 | 58 |
| Kraftkonstante | N/A (lbf/A) | 40.8 (9.17) | 25.8 (5.80) | 40.8 (9.17) | 25.8 (5.80) |
| Max. Strom @ 72VDC | A | 5.0 | 11.9 | 5.0 | 11.9 |
| Max. Strom @ 48VDC | A | 3.3 | 8.0 | 3.3 | 8.0 |
| Max. Gesch. @ 72VDC | m/s (in/s) | 1.6 (64) | 2.6 (101) | 1.6 (64) | 2.6 (101) |
| Max. Gesch. @ 48VDC | m/s (in/s) | 1.1 (43) | 1.7 (67) | 1.1 (43) | 1.7 (67) |
| Phasenwider. 25/80 °C | Ohm | 11.7/14.2 | 4.9/5.9 | 11.7/14.2 | 4.9/5.9 |
| Phaseninduktivität | mH | 6.0 | 2.4 | 6.0 | 2.4 |
| Therm. Widerstand | °K/W | 2.3 | 2.2 | 2.3 | 2.2 |
| Therm. Zeitkonstante | sec | 3400 | 3200 | 3400 | 3200 |
| Statordurchmesser | mm (in) | 37 (1.46) | 37 (1.46) | 37 (1.46) | 37 (1.46) |
| Statorlänge | mm (in) | 336 (13.23) | 336 (13.23) | 347 (13.66) | 347 (13.66) |
| Statormasse | g (lb) | 1385 (3.05) | 1385 (3.05) | 1385 (3.05) | 1385 (3.05) |
| Läuferdurchmesser | mm (in) | 20 (0.79) | 20 (0.79) | 20 (0.79) | 20 (0.79) |
| Läuferlänge | mm (in) | 1600 (62.99) | 1600 (62.99) | 1600 (62.99) | 1600 (62.99) |
| Läufermasse | g (lb) | 3622 (7.99) | 3622 (7.99) | 3622 (7.99) | 3622 (7.99) |
| Wiederholgenauigkeit | mm (in) | ±0.05 (±0.0020) | ±0.05 (±0.0020) | ±0.05 (±0.0020) | ±0.05 (±0.0020) |
| Linearität | % | ±0.10 | ±0.10 | ±0.10 | ±0.10 |
| Wiederholgenauigk. ES | mm (in) | ±0.01 (±0.0004) | ±0.01 (±0.0004) | ±0.01 (±0.0004) | ±0.01 (±0.0004) |
| Linearität ES | mm (in) | ±0.01 (±0.0004) | ±0.01 (±0.0004) | ±0.01 (±0.0004) | ±0.01 (±0.0004) |

Hub-Zeit Diagramm

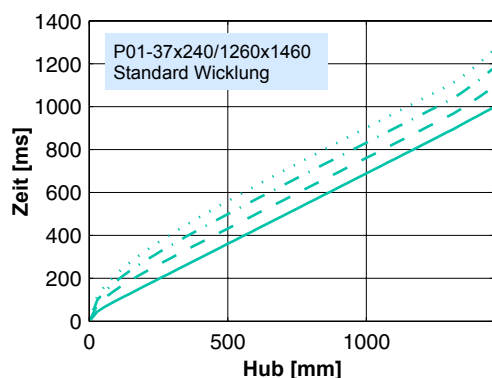

15.0 kg
10.0 kg
5.0 kg
0.0 kg

Bewegter Stator

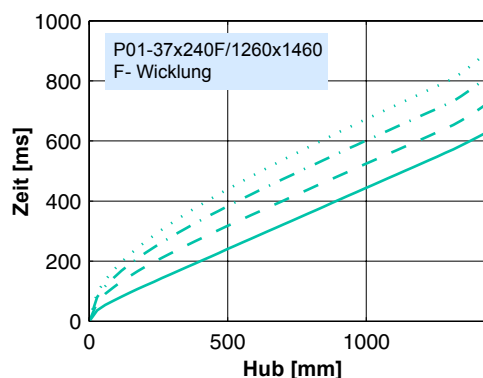

15.0 kg
10.0 kg
5.0 kg
0.0 kg

Bewegter Stator

Stecker Typ

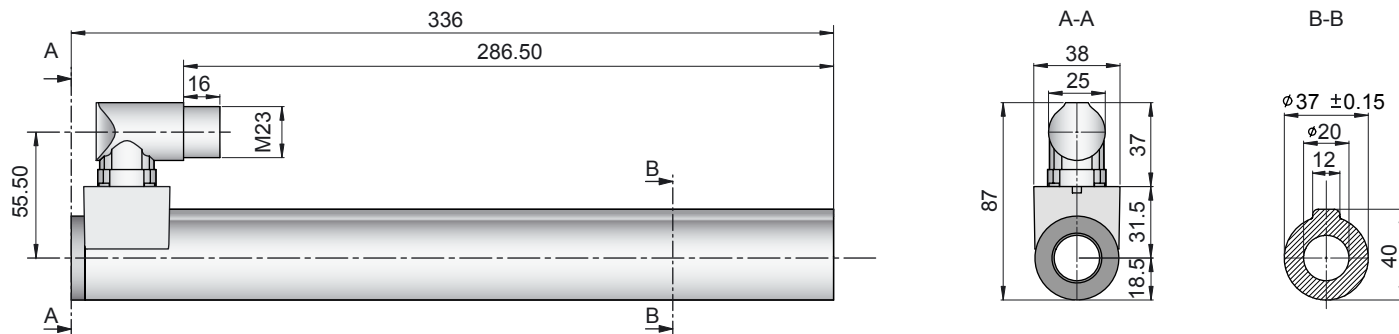

| Linearmotor | | Stator | | Läufer | |
|-------------------------|----------|----------------|-----------|--------|-------------------|
| Typ | Art. Nr. | Typ | Art. Nr. | Typ | Art. Nr. |
| P01-37x240/1260x1460-C | --> | PS01-37x240-C | 0150-1224 | & | PL01-20x1600/1520 |
| P01-37x240F/1260x1460-C | --> | PS01-37x240F-C | 0150-1225 | & | PL01-20x1600/1520 |
| | | | | | 0150-1344 |

Kabel Typ

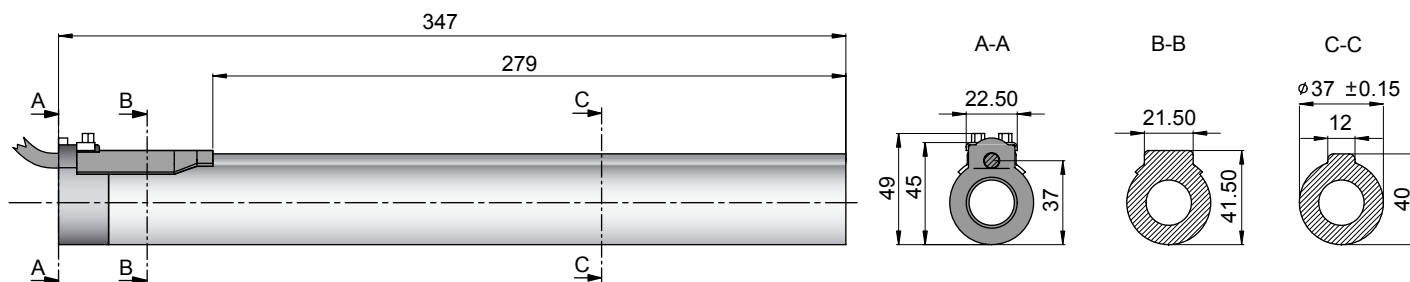

| Linearmotor | | Stator | | Läufer | |
|---------------------------|----------|------------------|-----------|--------|-------------------|
| Typ | Art. Nr. | Typ | Art. Nr. | Typ | Art. Nr. |
| P01-37x240/1260x1460 | --> | PS01-37x240 | 0150-1203 | & | PL01-20x1600/1520 |
| P01-37x240/1260x1460-C20 | --> | PS01-37x240-C20 | 0150-1238 | & | PL01-20x1600/1520 |
| P01-37x240F/1260x1460-C20 | --> | PS01-37x240F-C20 | 0150-1239 | & | PL01-20x1600/1520 |
| | | | | | 0150-1344 |

Läufer

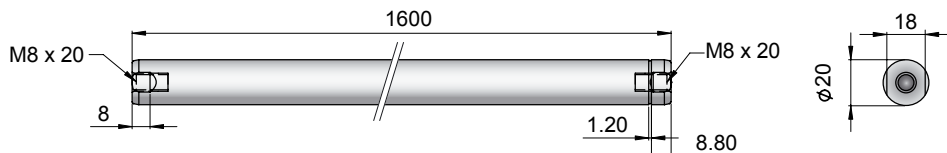

| Standard Läufer | | Standard Läufer | | PL01-20x1600/1520 | |
|-----------------|--|---|--|---------------------|-------------|
| Spezialläufer | | Heavy Duty Läufer mit WC/C-Beschichtung | | PL02-20x1600/1520 | |
| | | Lochläufer Innendurchmesser 6.5mm | | PL01-20x1600/1520-L | |
| | | | | | auf Anfrage |

Stecker

| Motor Steckerbelegung | | P01-37...-C | | P01-37...-C20 | | P01-37... | |
|-----------------------|----------------|-------------|----|---------------|--|-----------|--|
| Kabellänge: | | 1.5m | | 0.2m | | | |
| Ph 1+ | rot | A | 1 | | | | |
| Ph 1- | pink | B | 2 | | | | |
| Ph 2+ | blau | C | 3 | | | | |
| Ph 2- | grau | D | 4 | | | | |
| +5VDC | weiss | E | 5 | | | | |
| GND | innerer Schirm | F | 6 | | | | |
| Sinus | gelb | G | 7 | | | | |
| Cosinus | grün | H | 8 | | | | |
| Temp. | schwarz | L | 9 | | | | |
| Schirm | äusserer Schi. | Geh. | 10 | | | | |

Zubehör

